

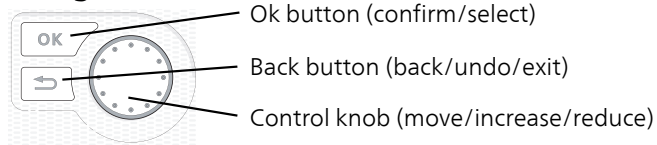

Installer manual
SMO 40
Control module

Quick guide

Navigation



A detailed explanation of the button functions can be found on page 34.

How to scroll through menus and make different settings is described on page 36.

Set the indoor climate

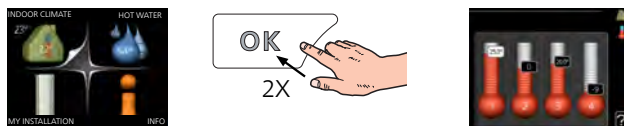

The mode for setting the indoor temperature is accessed by pressing the OK button twice, when in the start mode in the main menu.

Increase hot water volume



To temporarily increase the amount of hot water (if a hot water heater is installed to your SMO 40), first turn the control knob to mark menu 2 (water droplet) and then press the OK button twice.

In event of disturbances in comfort

If a disturbance in comfort of any type occurs there are some measures that can be taken before you need to contact your installer. See page 53 for instructions.

Table of Contents

1 Important information	4	Setting hot water circulation	32
Safety information	4	Pool	32
2 Delivery and handling	7	SG Ready	33
Mounting	7	7 Control - Introduction	34
Supplied components	7	Display unit	34
3 The Control Module Design	8	Menu system	35
Electrical components	8	8 Control	38
4 Pipe connections	9	Menu 1 - INDOOR CLIMATE	38
General	9	Menu 2 - HOT WATER	39
Docking alternatives	10	Menu 3 - INFO	39
5 Electrical connections	15	Menu 4 - MY SYSTEM	40
General	15	Menu 5 - SERVICE	41
Connections	18	9 Service	50
Optional connections	21	Service actions	50
Connecting accessories	27	10 Disturbances in comfort	53
6 Commissioning and adjusting	28	Manage alarm	53
Preparations	28	Troubleshooting	53
Commissioning with NIBE air/water heat pump	28	Additional heating only	54
Commissioning with additional heating only	28	11 Accessories	55
Check the reversing valve	28	12 Technical data	57
Check AUX socket	28	Dimensions and setting-out coordinates	57
Cooling mode	28	Technical specifications	58
Start guide	29	Electrical circuit diagram	59
Setting the cooling/heating curve	30	Index	65

1 Important information

Safety information

This manual describes installation and service procedures for implementation by specialists.

This appliance can be used by children aged from 8 years and above and persons with reduced physical, sensory or mental capabilities or lack of experience and knowledge if they have been given supervision or instruction concerning use of the appliance in a safe way and understand the hazards involved. Children shall not play with the appliance. Cleaning and user maintenance shall not be made by children without supervision.

Rights to make any design or technical modifications are reserved.

©NIBE 2015.

Symbols



NOTE

This symbol indicates danger to machine or person.



Caution

This symbol indicates important information about what you should observe when maintaining your installation.



TIP

This symbol indicates tips on how to facilitate using the product.

Marking

SMO 40 is CE marked and fulfils IP21.

The CE marking means that NIBE ensures that the product meets all regulations that are placed on it based on relevant EU directives. The CE mark is obligatory for most products sold in the EU, regardless where they are made.

IP21 means that objects with a diameter larger than or equivalent to 12.5 mm cannot penetrate and cause damage and that the product is protected against vertically falling drops of water.

Serial number

The serial number can be found on the upper side of the cover on the control module.

Serial number



Caution

Always give the product's serial number when reporting a fault.

Country specific information

Installer manual

This installer manual must be left with the customer.

Inspection of the installation

Current regulations require the heating installation to be inspected before it is commissioned. The inspection must be carried out by a suitably qualified person. Fill in the page for information about installation data in the User manual.

✓	Description	Notes	Signature	Date
	Electricity (page 15)			
	Communication, heat pump			
	Supply connected 230 V			
	Outside sensor			
	Room sensor			
	Temperature sensor, hot water charging			
	Temperature sensor, hot water top			
	Temperature sensor, external flow line			
	Temperature sensor, external return line			
	Charge pump			
	Shuttle valve			
	AUX 1			
	AUX 2			
	AUX 3			
	AUX 4			
	AUX 5			
	AUX 6			
	AA3-X7			
	Dipswitch			
	Miscellaneous			
	Checking additional heater			
	Checking the function of the reversing valve			
	Checking charge pump function			
	Completed installation check of heat pump and associated equipment			

Contact information

- AT KNV Energietechnik GmbH**, Gahberggasse 11, 4861 Schörfling
Tel: +43 (0)7662 8963-0 Fax: +43 (0)7662 8963-44 E-mail: mail@knv.at www.knv.at
- CH NIBE Wärmetechnik c/o ait Schweiz AG**, Industriepark, CH-6246 Altishofen
Tel: (52) 647 00 30 Fax: (52) 647 00 31 E-mail: info@nibe.ch www.nibe.ch
- CZ Druzstevni zavody Drazice s.r.o.**, Drazice 69, CZ - 294 71 Benatky nad Jizerou
Tel: +420 326 373 801 Fax: +420 326 373 803 E-mail: nibe@nibe.cz www.nibe.cz
- DE NIBE Systemtechnik GmbH**, Am Reiherpfahl 3, 29223 Celle
Tel: 05141/7546-0 Fax: 05141/7546-99 E-mail: info@nibe.de www.nibe.de
- DK Vølund Varmeteknik A/S**, Member of the Nibe Group, Brogårdsvej 7, 6920 Videbæk
Tel: 97 17 20 33 Fax: 97 17 29 33 E-mail: info@volundvt.dk www.volundvt.dk
- FI NIBE Energy Systems OY**, Juurakkotie 3, 01510 Vantaa
Puh: 09-274 697 0 Fax: 09-274 697 40 E-mail: info@nibe.fi www.nibe.fi
- FR NIBE Energy Systems France Sarl**, Zone industrielle RD 28, Rue du Pou du Ciel, 01600 Reyrieux
Tel : 04 74 00 92 92 Fax : 04 74 00 42 00 E-mail: info@nibe.fr www.nibe.fr
- GB NIBE Energy Systems Ltd**, 3C Broom Business Park, Bridge Way, Chesterfield S41 9QG
Tel: 0845 095 1200 Fax: 0845 095 1201 E-mail: info@nibe.co.uk www.nibe.co.uk
- NL NIBE Energietechnik B.V.**, Postbus 634, NL 4900 AP Oosterhout
Tel: 0168 477722 Fax: 0168 476998 E-mail: info@nibenl.nl www.nibenl.nl
- NO ABK AS**, Brobekkveien 80, 0582 Oslo, Postadresse: Postboks 64 Vollebakk, 0516 Oslo
Tel. sentralbord: +47 23 17 05 20 E-mail: post@abkklima.no www.nibeenergysystems.no
- PL NIBE-BIAWAR Sp. z o. o.** Aleja Jana Pawła II 57, 15-703 BIAŁYSTOK
Tel: 085 662 84 90 Fax: 085 662 84 14 E-mail: sekretariat@biawar.com.pl www.biawar.com.pl
- RU © "EVAN" 17**, per. Boynovskiy, Nizhny Novgorod
Tel./fax +7 831 419 57 06 E-mail: info@evan.ru www.nibe-evan.ru
- SE NIBE AB Sweden**, Box 14, Hannabadsvägen 5, SE-285 21 Markaryd
Tel: +46-(0)433-73 000 Fax: +46-(0)433-73 190 E-mail: info@nibe.se www.nibe.se

For countries not mention in this list, please contact Nibe Sweden or check www.nibe.eu for more information.

2 Delivery and handling

Mounting

NOTE
 For wall mounting, use the mounting adapted for the base.

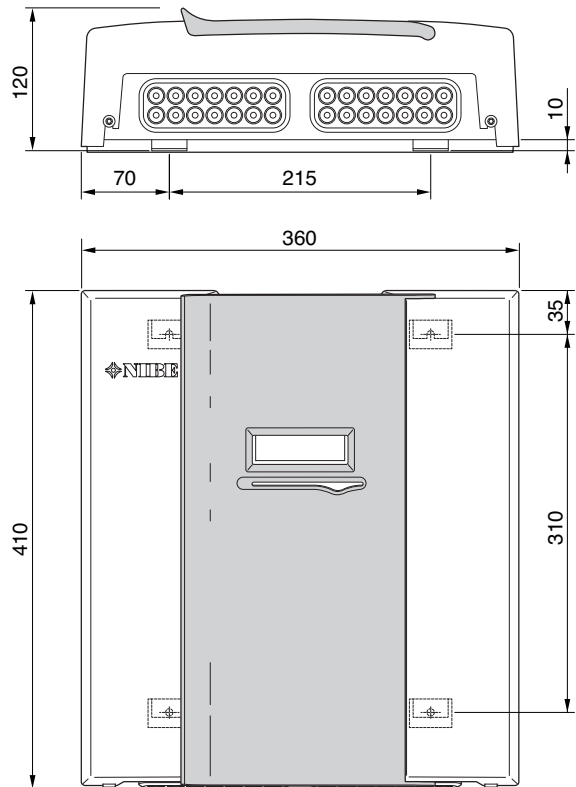

Use all mounting points and install SMO 40 upright flat against the wall without any part of the control module protruding out beyond the edge of the wall.

Leave at least 100 mm free space around the control module to facilitate access and cable routing on installation and service.

NOTE
 Access the screws for installing the front cover from underneath.

Supplied components



Outside sensor

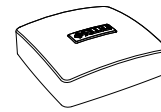

Room sensor

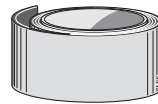

Insulation tape

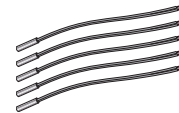

Temperature sensor

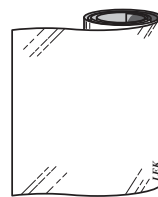

Aluminium tape



Cable ties



Heating pipe paste



Current sensor

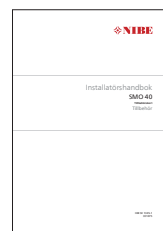

IHB SMO 40 Accessory board

3 The Control Module Design

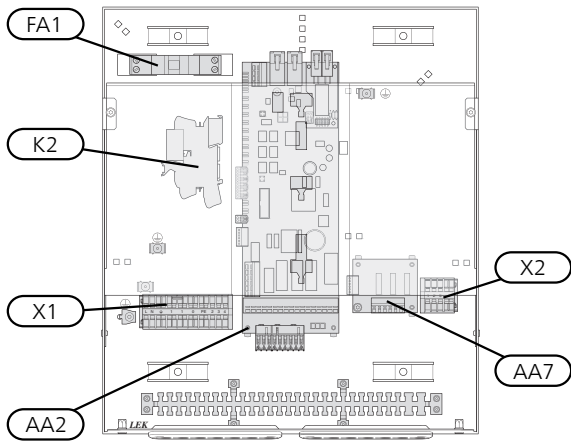
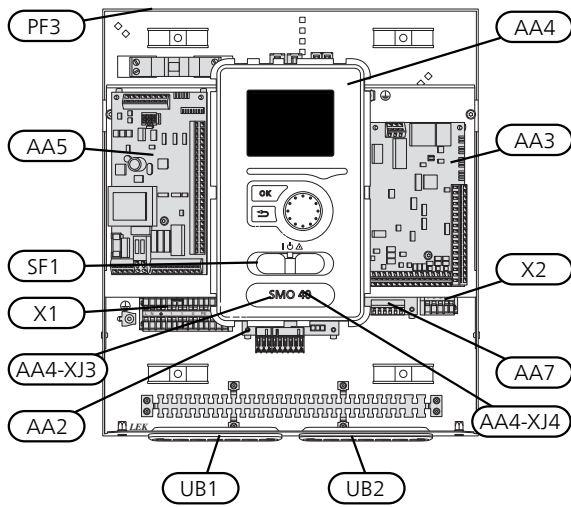

Electrical components

- AA2 Base card
- AA3 Input circuit board
- AA4 Display unit
 - AA4-XJ3 USB socket
 - AA4-XJ4 Service outlet (No function)
- AA5 Accessory card
- AA7 Extra relay circuit board
- FA1 Miniature circuit-breaker
- K2 Emergency mode relay
- X1 Terminal block, incoming electrical supply
- X2 Terminal block, AUX4 - AUX6
- SF1 Switch
- PF3 Serial number plate
- UB1 Cable grommet, incoming supply electricity, power for accessories
- UB2 Cable gland, signal

Designations in component locations according to standard IEC 81346-1 and 81346-2.

4 Pipe connections

General









Pipe installation must be carried out in accordance with current norms and directives. See manual for compatible NIBE air/water heat pump for installation of the heat pump.

Compatible NIBE air/water heat pumps

Compatible NIBE air/water heat pumps must be equipped with a control card that has at least the software version given in the following list. The control card version is displayed in the heat pump's display (if applicable) upon start-up.

Product	Software version
F2015	55
F2016	55
F2020	118
F2025	55
F2026	55
F2030	all versions
F2040	all versions
F2300	55

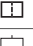
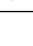
Symbol key

Symbol	Meaning
	Shut-off valve
	Trim valve
	Shunt / shuttle valve
	Safety valve
	Temperature sensor
	Pressure gauge
	Circulation pump
	Particle filter
	Auxiliary relay

Temperature sensor installation on pipe

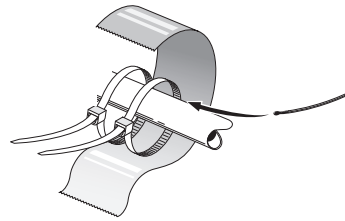

The temperature sensors are mounted with heat conducting paste, cable ties (the first cable tie is secured to the pipe in the middle of the sensor and the other cable tie is mounted approx. 5 cm beyond the sensor) and aluminium tape. Then insulate with supplied insulation tape.

NOTE
 Sensor and communication cables must not be placed near power cables.

Docking alternatives

SMO 40 can be connected with other products from NIBE in several different ways, some of which are shown below (accessories may be required).

Further option information is available at www.nibe.eu and in the respective assembly instructions for the accessories used. See page 55 for a list of the accessories that can be used with SMO 40.

Installations with SMO 40 can produce heating and hot water. Cooling can also be produced, but it depends on the heat pump that is used.

On cold days of the year when the access to energy from the air is reduced the additional heating can compensate and help to produce heat. The additional heating is also good to have as assistance if the heat pump ends up outside its working range or if it has been blocked for any reason.



NOTE

The heating medium side and the hot water side must be fitted with the necessary safety equipment in accordance with the applicable regulations.

This is the outline diagram. Actual installations must be planned according to applicable standards.

Explanation

AA25	SMO 40
BT1	Outdoor sensor ¹⁾
BT6	Temperature sensor, hot water charging ¹⁾
BT7	Temperature sensor, hot water top ¹⁾
BT25	Temperature sensor, external supply line ¹⁾
BT50	Room sensor ¹⁾
BT63	Temperature sensor, external supply line after electric heater
BT71	Temperature sensor, external return line ¹⁾
GP10	Circulation pump, Heating medium
QN10	Reversing valve, Hot water/Heating medium ²⁾
CL11 to 12	Pool system 1 to 2
AA25	Unit box with accessory card ²⁾
BT51	Temperature sensor, pool ²⁾
EP5	Exchanger, pool
GP9	Circulation pump, pool
HQ4	Particle filter, pool
QN10	Three way valve, pool ²⁾
RN10	Trim valve
EB1	Additional heat
CM5	Expansion vessel
EB1	Immersion heater
FL10	Safety valve
KA1	Auxiliary relay/Contactor ²⁾
RN11	Trim valve
QM42 to 43	Shut-off valve
EB101 to 104	Heat pump system
AA25	Unit box with accessory card ²⁾
BT3	Temperature sensor, return line ³⁾
BT12	Temperature sensor, condenser supply line ³⁾
EB101 to 104	Heat pump
FL10	Safety valve
GP10	External circulation pump, climate system
GP12	Charge pump ²⁾
HQ1	Particle filter ³⁾
QM1	Drain valve, Heating medium
QM31	Shut-off valve, Heating medium, Flow
QM32	Shut off valve, Heating medium, Return
QM43	Shut-off valve
RM11	Non-return valve
EP21 to 22	Climate system 2 to 3
AA25	Unit box with accessory card ²⁾
BT2	Temperature sensor, heating medium supply ²⁾
BT3	Temperature sensor, heating medium return ²⁾
GP20	Circulation pump ²⁾

QN25 Shunt valve²⁾

EQ1 Cooling system

AA25 Unit box with accessory card²⁾
BT64 Temperature sensor, cooling supply line²⁾
CP6 Single jacket accumulator tank, cooling
GP13 Circulation pump, cooling
QN12 Reversing valve, Cooling/Heating²⁾

QZ1 Hot water circulation

AA25 Unit box with accessory card²⁾
BT70 Temperature sensor, outgoing hot water²⁾
GP11 Circulation pump, domestic hot water circulation
FQ1 Mixer valve, hot water
RM23 to 24 Non-return valve
RN20 to 21 Trim valve

Miscellaneous

CM1 Expansion vessel closed, Heating medium
CP5 Buffer vessel (UKV)
CP10 to 11 Accumulator tank with hot water heating
EB10 Hot water/additional water heater
EB20 Immersion heater
FL2 Safety valve, Heating medium
KA1 Auxiliary relay/Contactor
RN10, Trim valve
RN43, RN60
to 63

1) Included in and supplied SMO 40

2) Included in and supplied accessory

3) Included in and supplied NIBE heat pump (can vary depending on heat pump).

Designations according to standards 81346-1 and 81346-2.

Compatible NIBE air/water heat pump together with SMO 40 - docking step controlled additional heat before reversing valve for hot water and cooling function (4 pipe system)

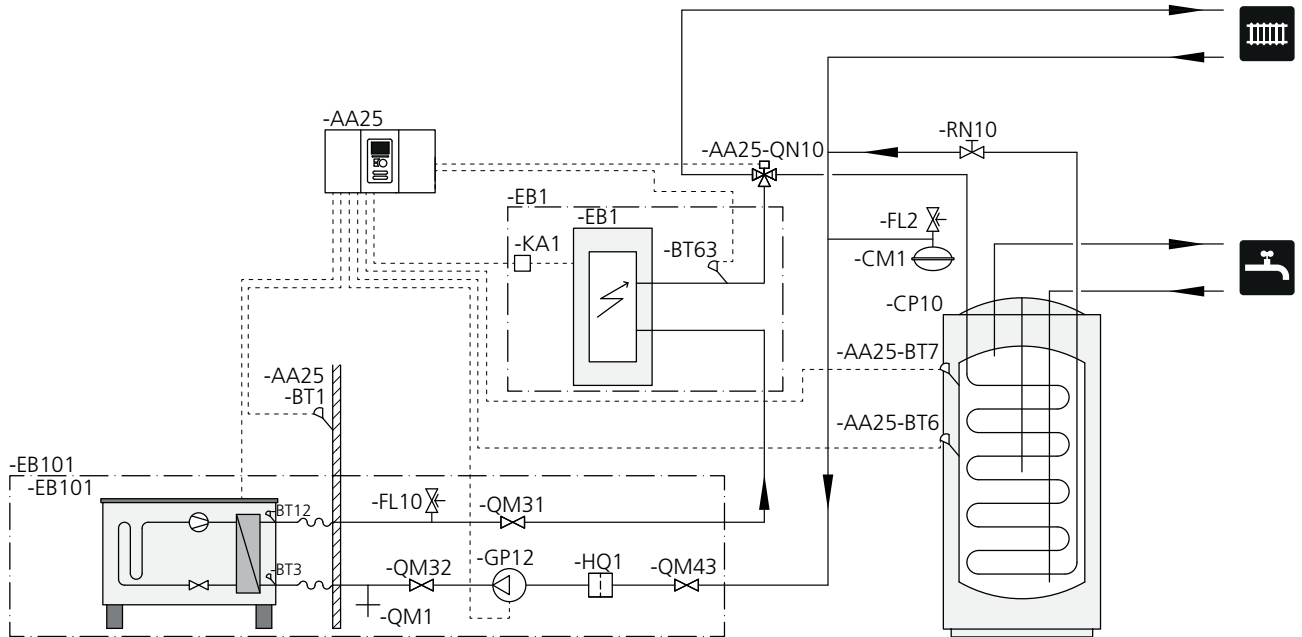

NOTE

NIBE does not supply all components in this outline diagram.

This installation alternative is suitable for simpler installations with a focus on low installation costs.

SMO 40 (AA25) starts and stops the heat pump (EB101) to meet the heat and hot water demand of the installation. At simultaneous heating and hot water demand the reversing valve switches (AA25-QN10) periodically between the climate system and the water heater/accumulator tank (CP10). When the hot water heater/accumulator tank is fully charged (CP10), the reversing valve switches (AA25-QN10) to the climate system.

Additional heat (EB1) is connected automatically when the power demand for the installation exceeds the heat pump capacity. This is used for both heating and charging hot water.

The additional heat can also be used if a higher temperature in the hot water is required than the heat pump can produce.

Compatible NIBE air/water heat pump together with SMO 40 - docking step controlled additional heat after reversing valve for hot water and accessory for extra climate system, pool and cooling

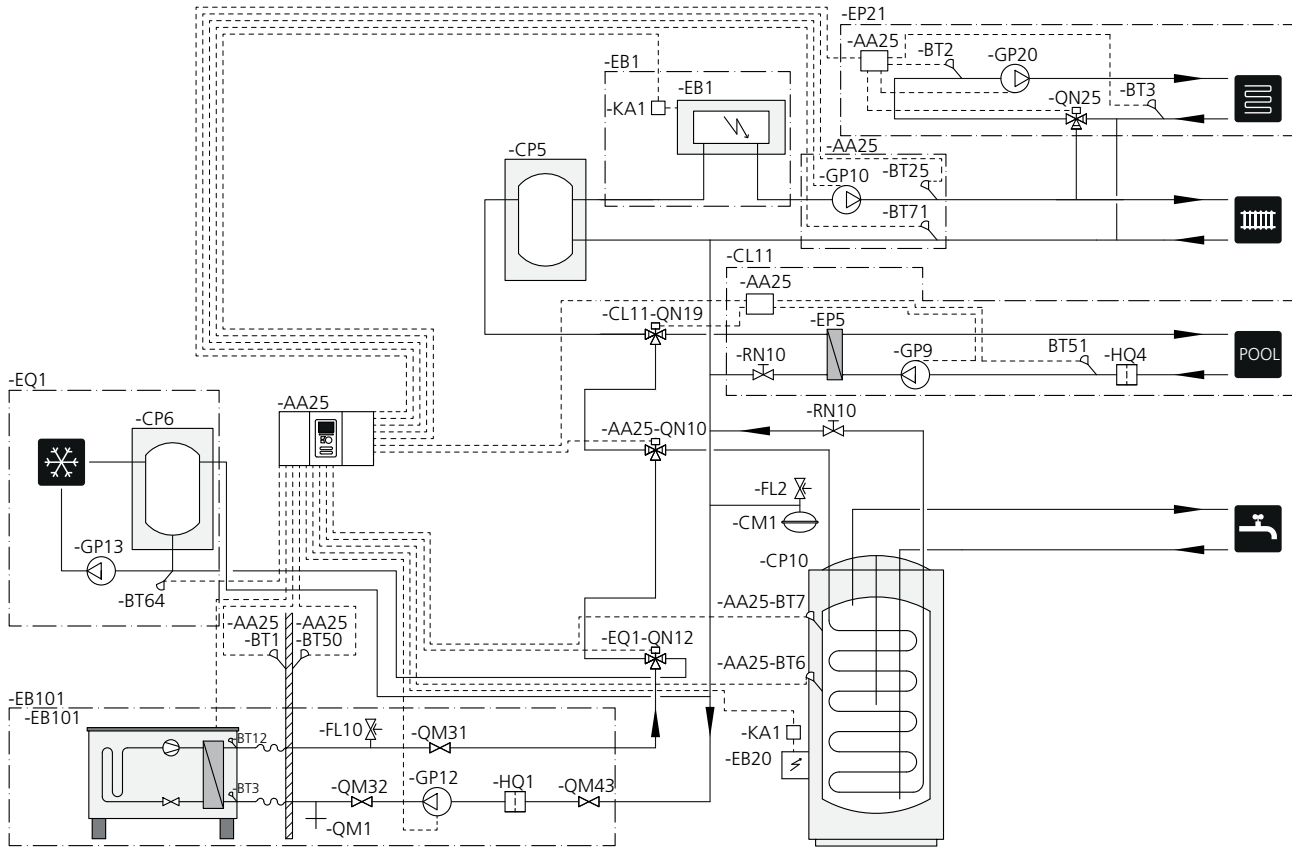

NOTE
 NIBE does not supply all components in this outline diagram.

This installation alternative is suitable for more complex installations with a focus on comfort.

SMO 40 (AA25) starts and stops the heat pump (EB101) to meet the heat and hot water demand of the installation. At simultaneous heating and hot water demand the reversing valve switches (AA25-QN10) periodically between the climate system and the water heater/accumulator tank (CP10). When the water heater/accumulator tank is fully charged (CP10), the reversing valve switches (AA25-QN10) to the climate system and pool. When the pool needs heating the reversing valve (CL11-QN19) switches from the climate system to the pool system.

Additional heat (EB1) is connected automatically when the energy demand exceeds the heat pump capacity. Immersion heater (EB20) in the water heater/accumulator tank (CP10) is used during the time to produce hot water if the heat pump (EB101) is used for heating the building at the same time.

The immersion heater (EB20) can also be used if a higher temperature of hot water is required than the heat pump can produce.

During cooling operation (requires compatible heat pump) the reversing valve (EQ1-QN12) switches to the cooling system (EQ1). If several simultaneous demands occur while there is a cooling demand the installation reacts differently. In event of a hot water demand the reversing valve (EQ1-QN12) switches back and hot water is produced until the demand is fulfilled. In event of a heating demand the reversing valve (EQ1-QN12) instead switches periodically between the demands. If the cooling demand is met, the reversing valve switches back to basic mode (heat/hot water).

Compatible NIBE air/water heat pump together with SMO 40 and electric heater after reversing valve for hot water and pool and extra climate system (floating condensing)

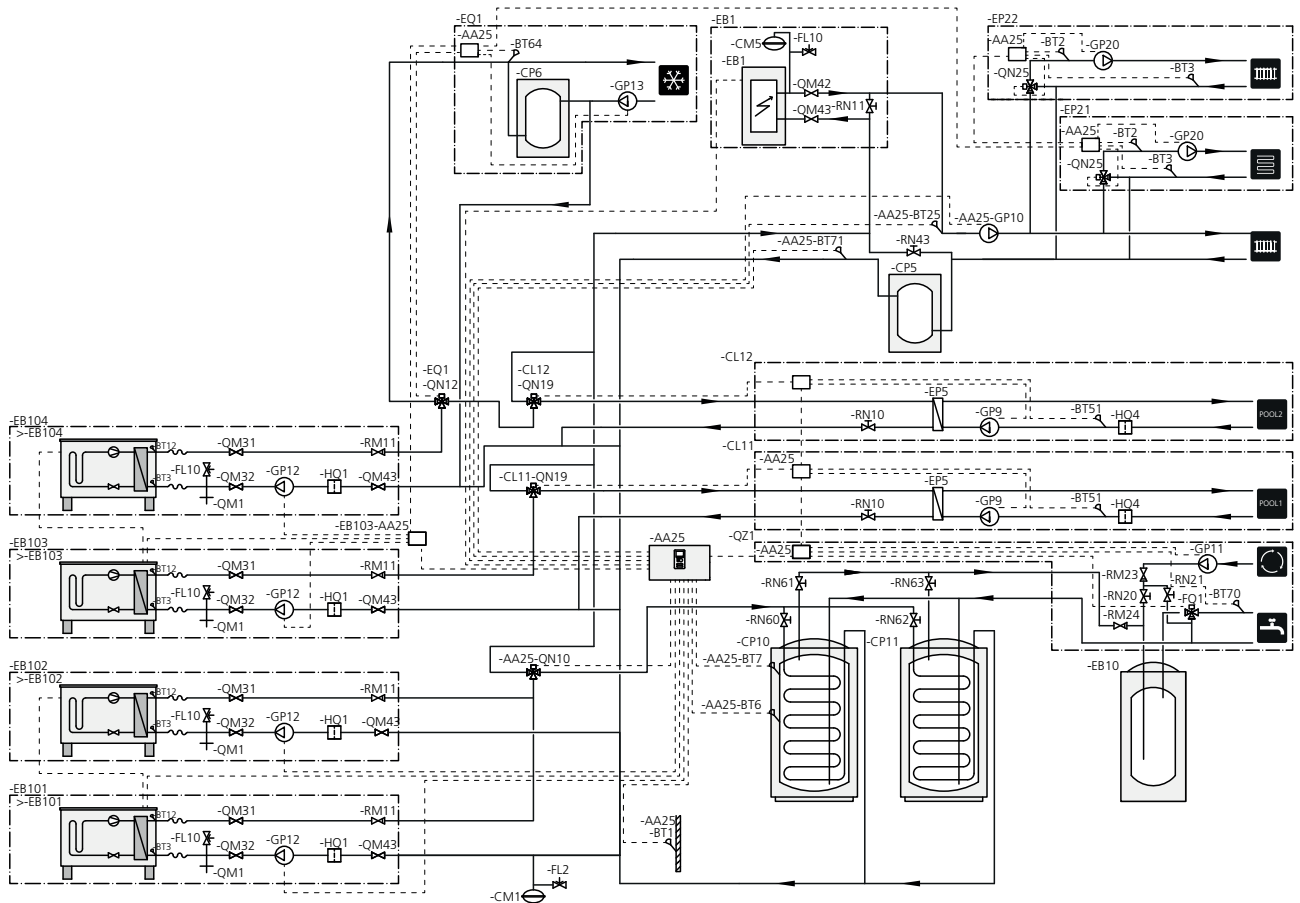

NOTE

NIBE does not supply all components in this outline diagram.



NOTE

Different types of demand (heating, hot water etc.) mean different supply and return temperatures as well as different flows to the heat pump.

When connecting pipes in installations with several compressors and different heating demands, ensure that these are separated so that different return temperatures are not mixed. Otherwise this can affect the heating installation's efficiency.

See outline diagram for example.

This installations alternative is suitable for more complex installations with a focus on comfort.

SMO 40 (AA25) starts and stops the heat pumps EB101) and (EB102) to meet the heat and hot water demand of the installation. The heat pump (EB103) is used for heating and pool heating and heat pump (EB104) is used for cooling, heating and pool heating.

At simultaneous heating and hot water demand the reversing valve switches (AA25-QN10) periodically between the climate system and the water heater/accumulator tank (CP10). When the hot water heater/accumulator tank is fully charged (CP10), the reversing valve switches (AA25-QN10) to the climate systems. When the pool needs heating the reversing valve (CL11-QN19) or (CL12-QN19) switches from the climate system to the pool system.

Additional heat (EB1) is connected automatically when the energy demand exceeds the heat pump capacity.

Additional water heating is obtained from the additional water heater (EB10).

During cooling operation (requires compatible heat pump) the reversing valve (EQ1-QN12) switches to the cooling system (EQ1). If several simultaneous demands occur while there is a cooling demand the installation reacts differently. In event of a heating demand the reversing valve (EQ1-QN12) instead switches periodically between the demands. If the cooling demand is met, the reversing valve switches back to basic mode (heat/hot water). In event of a pool heating demand the reversing valve (EQ1-QN12) switches back at the same time as the reversing valve (CL12-QN19) switches to the pool system (CL12) and pool heating is produced until the demand is fulfilled.

5 Electrical connections

General

- Disconnect SMO 40 before insulation testing the house wiring.
- If the building is equipped with an earth-fault breaker, SMO 40 should be equipped with a separate one.
- SMO 40 must be installed via an isolator switch with a minimum breaking gap of 3mm.
- For the electrical wiring diagram for the control module, see page 59.
- Communication and sensor cables to external connections must not be laid close to high current cables.
- The minimum area of communication and sensor cables to external connections must be 0.5 mm² up to 50 m, for example EKKX or LiYY or equivalent.
- Use a screened three core cable for communication with the heat pump.
- When cable routing in SMO 40, cable grommets (UB1 and UB2, marked in image) must be used.

NOTE

The switch (SF1) must not be moved to "I" or "Δ" until the boiler in the system has been filled with water. The compressor in the heat pump and any external addition can be damaged.

NOTE

Electrical installation and service must be carried out under the supervision of a qualified electrician. Cut the current with the circuit breaker before carrying out any servicing. Electrical installation and wiring must be carried out in accordance with the stipulations in force.

When installing SMO 40, NIBE's air/water heat pump and any addition must be current free.

NOTE

See outline diagram for your system for physical location of the temperature sensor that is to be installed.

Caution

The relay outputs on the accessory card (AA5) can have a max load of 2 A (230 V) in total.

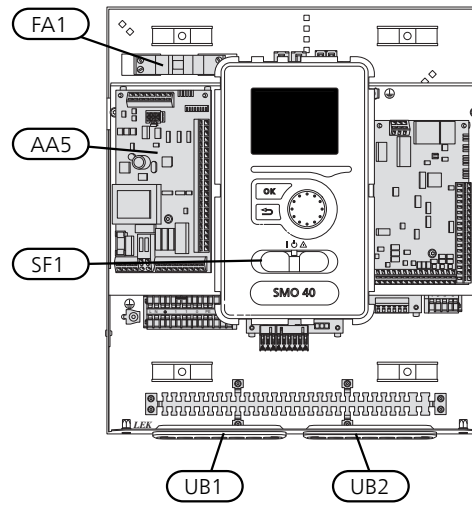

Miniature circuit-breaker

The control module operating circuit and parts of its internal components are internally fused by a miniature circuit-breaker (FA1).

Accessibility, electrical connection

The cover of the control module is opened using a Torx 25 driver. Assembly takes place in reverse order.

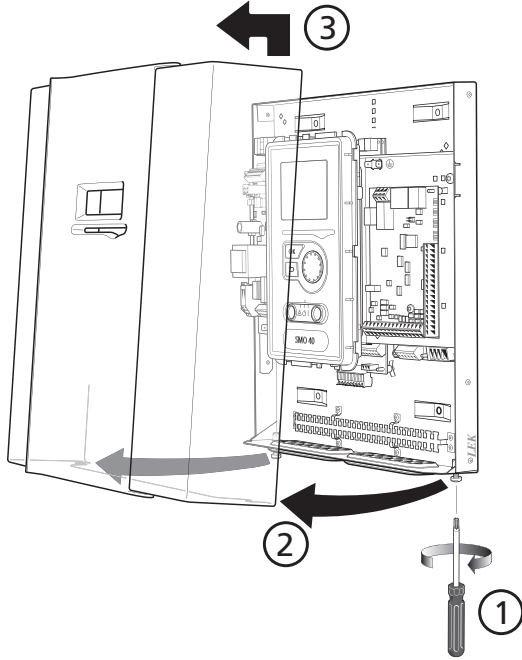

NOTE

The cover to access the base card is opened using a Torx 25 screwdriver.

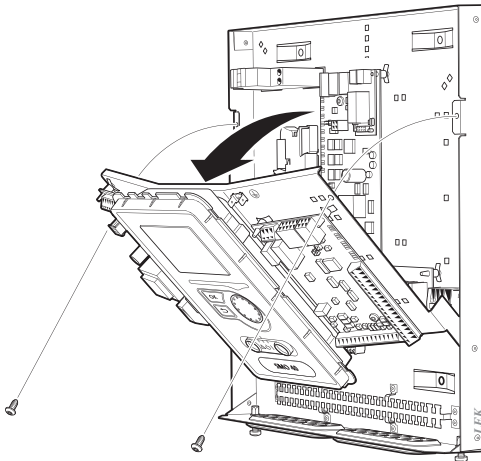

The display may need to be moved for easier access when connecting electrics. This is easily done by following these steps.

1.

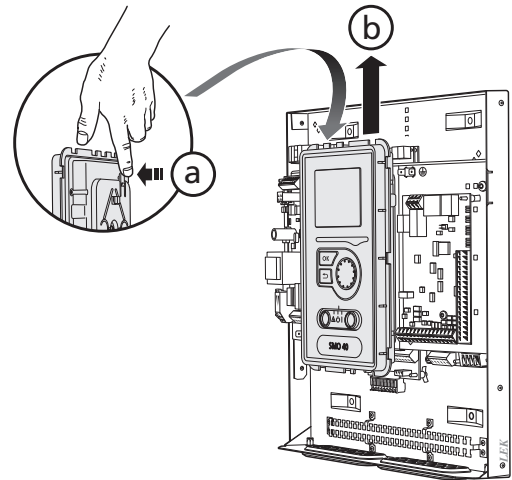

Press in the catch on the upper rear side of the display unit towards you (a) and move the display unit upwards (b) so that the mountings unhook from the panel.

2.

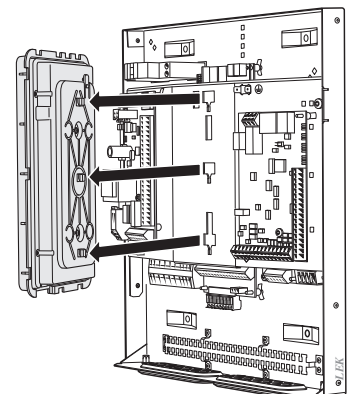

Lift the display unit from its mountings.

3.

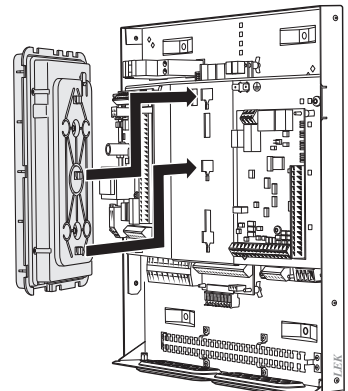

Align the two lower mountings on the reverse of the display unit with the two upper holes in the panel as illustrated.

4.

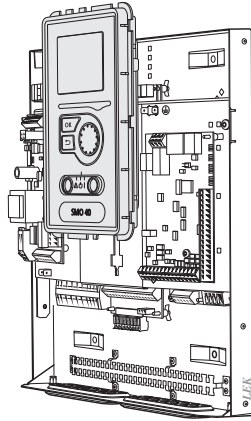

Secure the display on the panel.

5. When the electrical connection is ready the display must be reinstalled with three mounting points again, otherwise the front cover cannot be installed.

Cable lock

Use a suitable tool to release/lock cables in the heat pump terminal blocks.

Terminal block on the electrical card

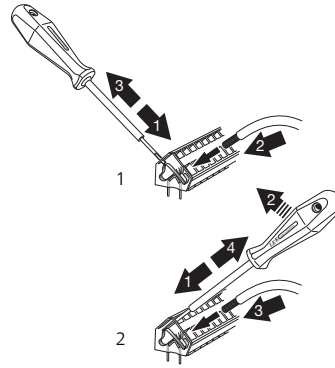

Terminal block

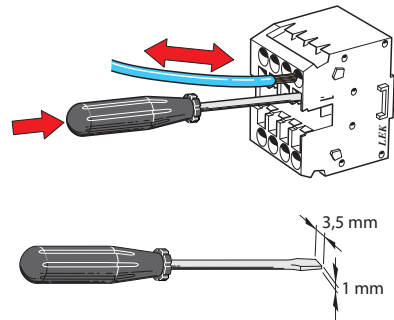

Connections



NOTE

To prevent interference, unscreened communication and/or sensor cables to external connections must not be laid closer than 20 cm from high voltage cables.

Power connection

SMO 40 must be installed via an isolator switch with a minimum breaking gap of 3mm. Minimum cable area must be sized according to the fuse rating used.

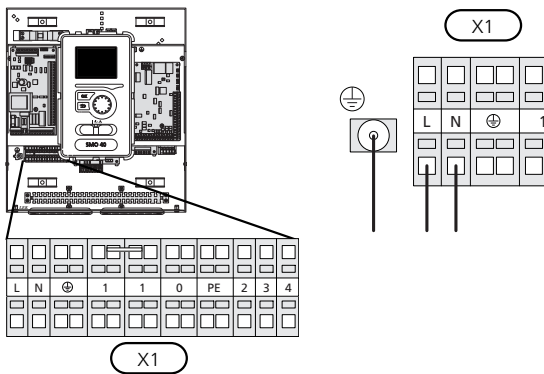

Tariff control

If the voltage to the compressor in the heat pump disappears for a certain period, simultaneous blocking of these must take place via software controlled input (AUX input) to avoid alarm, see page 24.

Connecting the charge pump for the heat pump 1 and 2

Connect circulation pump (EB101-GP12) as illustrated to terminal block X4:5 (PE), X4:6 (N) and X4:7 (230 V) on the base board (AA2).

Control signal for (EB101-GP12) is connected to terminal block X4:7 (GND) and X4:8 (PWM) on the input board (AA3) as illustrated.

If two heat pumps are connected to SMO 40 the circulation pump (EB102-GP12) must be connected to terminal blocks X4:12 (PE), X4:13 (N) and X4:15 (230 V) on the base board (AA2) as illustrated. Control signal for (EB102-GP12) is connected to terminal blocks X4:5 (GND) and X4:6 (PWM) on the input board (AA3) as illustrated.



TIP

Two charge pumps (four if the internal accessories card is used) can be connected to and controlled by SMO 40. More charge pumps can be connected if the accessories card is used, two pumps per card.

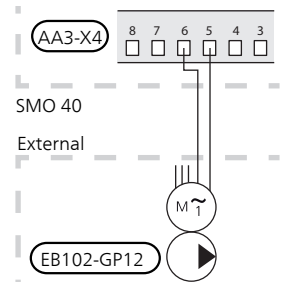
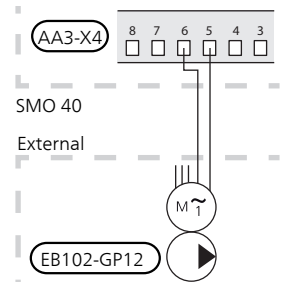
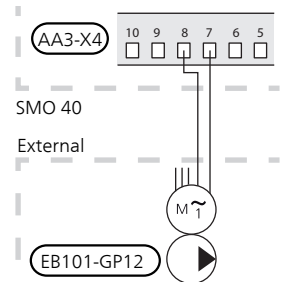
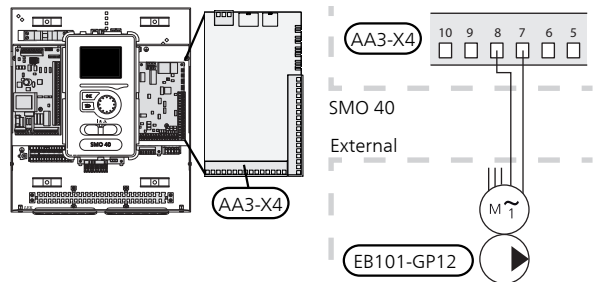
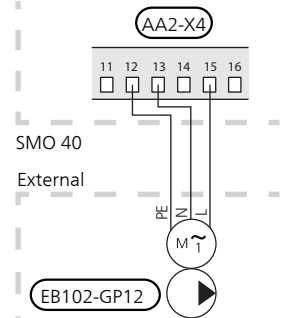
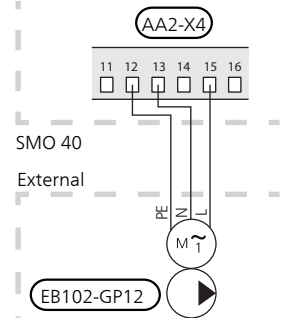
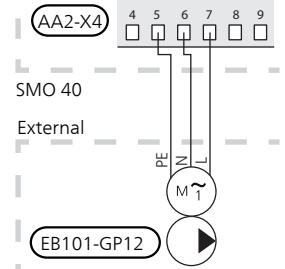
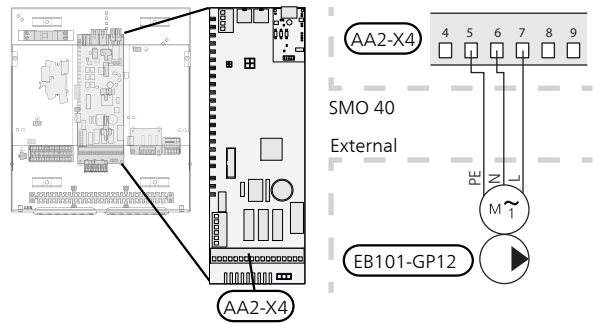

Communication with heat pump

Connect the heat pump (EB101) with a screened three core cable to terminal block X4:1 (A), X4:2 (B) and X4:3 (GND) on the accessory card (AA5) as illustrated.

If several heat pumps are to be connected to SMO 40 these must be connected in cascade as illustrated.

NOTE
 With accessories, up to 8 heat pumps can be controlled by SMO 40.

Caution
 Heat pumps with inverter controlled compressor can only be combined with other inverter controlled heat pumps of the same model.

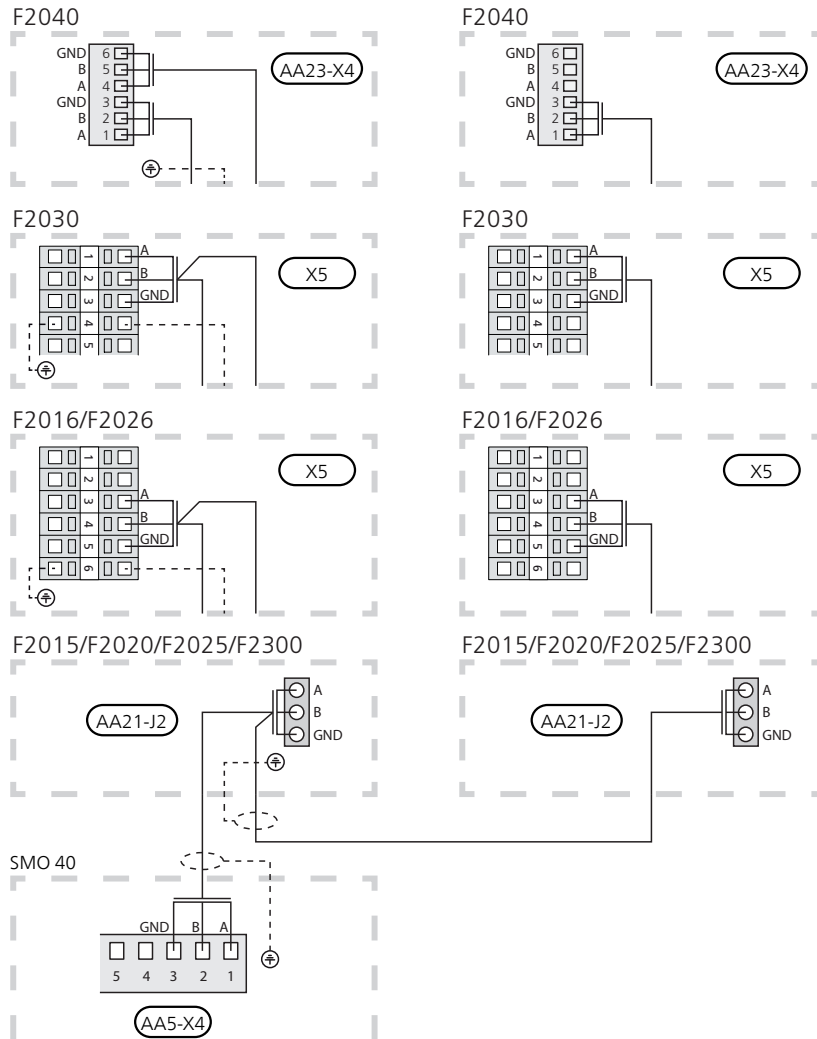
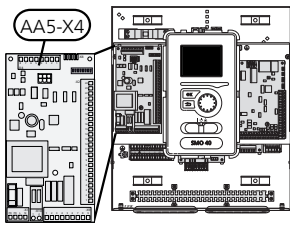

Outside sensor

Install the outside temperature sensor (BT1) in the shade on a wall facing north or north-west, so it is unaffected by the morning sun.

Connect the sensor to terminal block X6:1 and X6:2 on the input card (AA3). Use a twin core cable of at least 0.5 mm² cable area.

If a conduit is used it must be sealed to prevent condensation in the sensor capsule.

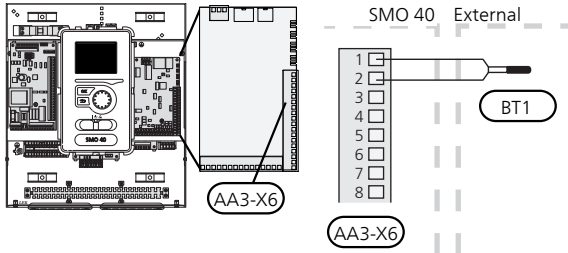

Temperature sensor, hot water charging

The temperature sensor, hot water charging (BT6) is placed in the submerged tube on the water heater.

Connect the sensor to terminal block X6:7 and X6:8 on the input card (AA3). Use a twin core cable of at least 0.5 mm² cable area.

Hot water charging is activated in menu 5.2 or in the start guide.

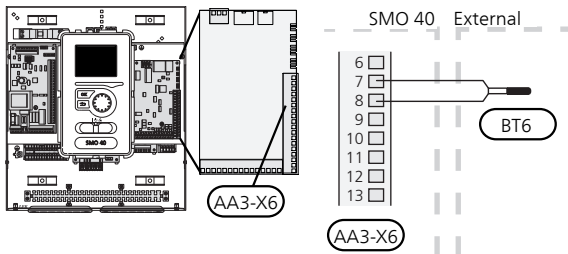

Temperature sensor, hot water top

A temperature sensor for hot water top (BT7) can be connected to SMO 40 to show the water temperature at the top of the tank (if it is possible to install a sensor at the top of the tank).

Connect the sensor to terminal block X6:15 and X6:16 on the input card (AA3). Use a twin core cable of at least 0.5 mm² cable area.

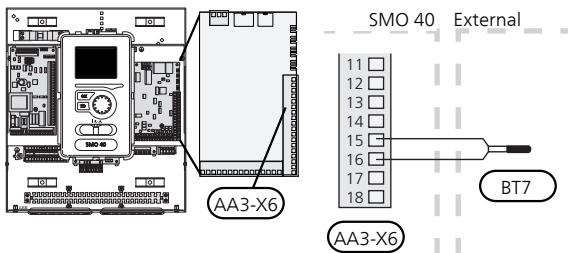

Temperature sensor, external flow line

Connect temperature sensor, external supply (BT25) (required for additional heat after reversing valve (QN10)), to terminal block X6:5 and X6:6 on the input card (AA3). Use a two core cable with a minimum 0.5 mm² cable area.

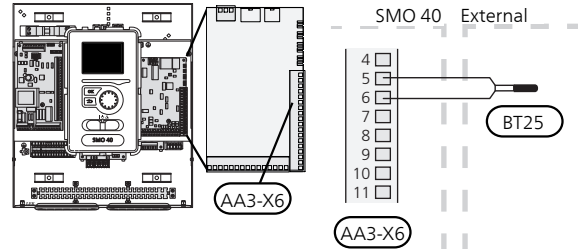

Temperature sensor, external return line

Connect temperature sensor, external return line (BT71) to terminal block X6:17 and X6:18 on the input card (AA3). Use a twin core cable of at least 0.5 mm² cable area.

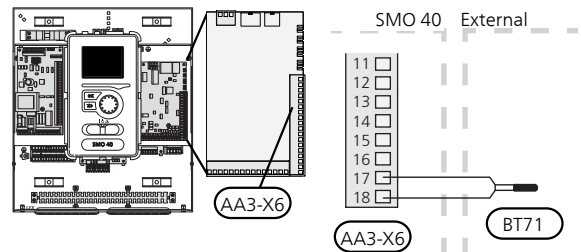

NOTE
 For docking that requires connection of other sensors. See "Possible selection for AUX inputs" on page 24.

Optional connections

Load monitor

When many power consumers are connected in the property at the same time as the electric addition is operating, there is a risk of the property's main fuse tripping. The control module has an integrated load monitor that controls the power steps for the electrical addition by disconnecting step by step in event of overload in a phase. Reconnection occurs when other current consumption is reduced.

Connecting current sensors

A current sensor (BE1 - BE3) should be installed on each incoming phase conductor in to the distribution box to measure the current. The distribution box is an appropriate installation point.

Connect the current sensors to a multi-core cable in an enclosure next to the distribution box. Use a multi-core cable of at least 0.5 mm² from the enclosure to the heat pump.

Connect the cable to terminal X4:1 to 4 where X4:1 is the common terminal block for the three current sensors.

The size of the property's main fuse is set in menu 5.1.12.

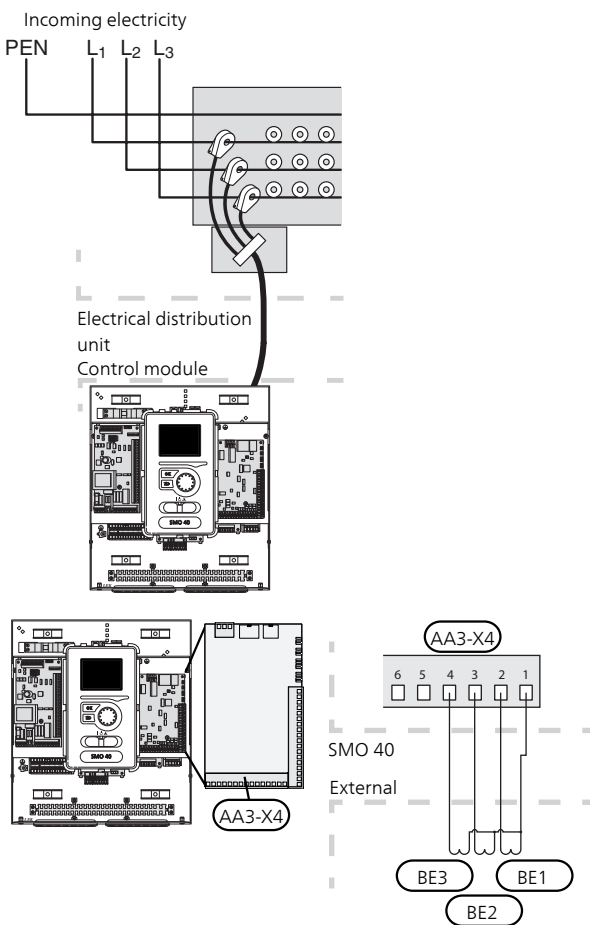

Room sensor

SMO 40 can be supplemented with a room sensor (BT50). The room temperature sensor has up to three functions:

1. Show current room temperature in the control module display.
2. Option of changing the room temperature in °C.
3. Makes it possible to change/stabilise the room temperature.

Install the sensor in a neutral position where the set temperature is required. A suitable location is on a free inner wall in a hall approx. 1.5 m above the floor. It is important that the sensor is not obstructed from measuring the correct room temperature by being located, for example, in a recess, between shelves, behind a curtain, above or close to a heat source, in a draft from an external door or in direct sunlight. Closed radiator thermostats can also cause problems.

The control module operates without the sensor, but if one wishes to read off the accommodation's indoor temperature in SMO 40 display the sensor must be installed. Connect the room sensor to terminal block X6:3 and X6:4 on the input card (AA3).

If the sensor is to be used to change the room temperature in °C and/or to change/stabilise the room temperature, the sensor must be activated in menu 1.9.4.

If the room sensor is used in a room with underfloor heating, it should only have an indicative function, not control of the room temperature.

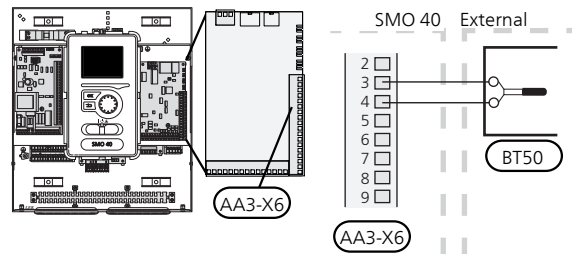

Caution
Changes of temperature in accommodation take time. For example, short time periods in combination with underfloor heating will not give a noticeable difference in room temperature.

Step controlled additional heat

NOTE
 Mark up any junction boxes with warnings for external voltage.

External step controlled additional heat can be controlled by up to three potential-free relays in the control module (3 step linear or 7 step binary). Alternatively two relays (2 step linear or 3 step binary) can be used for step controlled additional heat, which means that the third relay can be used to control the immersion heater in the water heater/accumulator tank. With the AXC 30 accessory, a further three potential-free relays are used for additional heat control, which then gives max 3 linear or 7 binary steps.

Step in occurs with at least 1 minute intervals and step outs with at least 3 seconds intervals.

Step 1 is connected to terminal block X2:2 on the additional relay board (AA7).

Step 2 is connected to terminal block X2:4 on the additional relay board (AA7).

Step 3 or immersion heater in the water heater/accumulator tank is connected to terminal block X2:6 on the additional relay board (AA7).

The settings for step controlled additional heat are made in menu 4.9.3 and menu 5.1.12.

All additional heat can be blocked by connecting a potential-free switch function to the software controlled input on terminal block X6 on the input board (AA3) or terminal block X2 (see page 24) which is selected in menu 5.4.

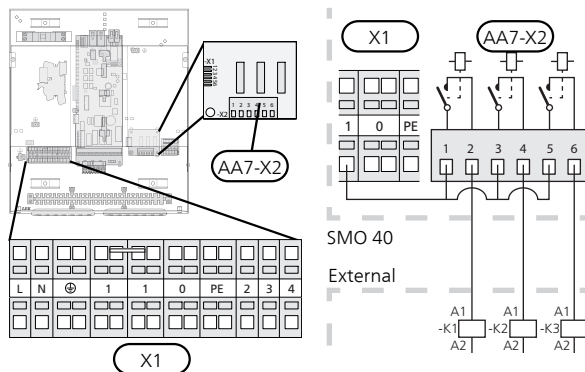

If the relays are to be used for control voltage, bridge the supply from terminal block X1:1 to X2:1, X2:3 and X2:5 on additional relay board (AA7). Connect the neutral from the external additional heat to terminal block X1:0.

With step controlled additional heat before the reversing valve

The electric additional heat will charge with the maximum permitted immersion heater output together with the compressor to conclude the hot water charging and return to charging the heating as soon as possible. This only occurs when the number of degree minutes is below the start value for the additional heat.

Shunt controlled additional heat

NOTE
 Mark up any junction boxes with warnings for external voltage.

This connection enables an external additional heater, e.g. an oil boiler, gas boiler or district heating exchanger to aid with heating.

SMO 40 controls a shunt valve and start signal to the additional heating using three relays. If the installation does not manage to keep the correct supply temperature, the additional heat starts. When the boiler sensor (BT52) displays approx. 55 °C, the SMO 40 transmits a signal to the shunt (QN11) to turn on the additional heat. The shunt (QN11) adjusts, so the true supply temperature agrees with the control system's theoretical, calculated, set point value. When the heating demand drops sufficiently, so the additional heat is no longer required, the shunt (QN11) closes completely. Factory set minimum run time for the boiler is 12 hours (can be set in menu 5.1.12).

The settings for shunt controlled additional heat are made in menu 4.9.3 and menu 5.1.12.

Connect the shunt motor (QN11) to terminal block X2:4 (230 V, close) and 6 (230 V, open) on the additional relay board (AA7) and terminal block X1:0 (N).

To control switching the additional heat on and off, connect it to terminal block X2:2 on the extra relay board (AA7).

All additional heat can be blocked by connecting a potential-free switch function to the software controlled input on terminal block X6 on the input board (AA3) or terminal block X2 (see page 24) which is selected in menu 5.4.

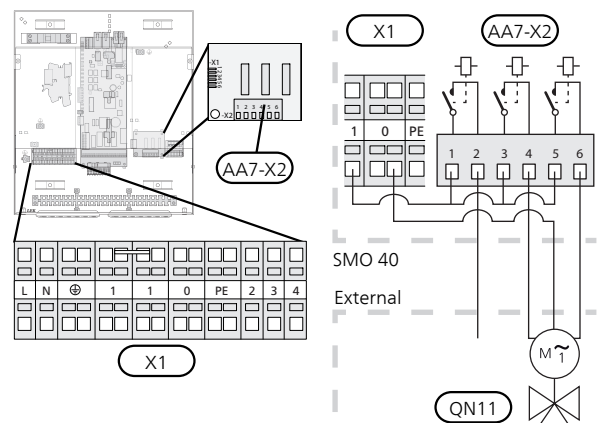

If the relays are to be used for control voltage, bridge the supply from terminal block X1:1 to X2:1, X2:3 and X2:5 on additional relay board (AA7).

Relay output for emergency mode

NOTE
 Mark up any junction boxes with warnings for external voltage.

When the switch (SF1) is in "Δ" mode (emergency mode) the following components are activated (if they are connected).

- the circulation pumps (EB101-GP12 and EB102-GP12)
- external circulation pump (GP10)
- the potential free switching emergency mode relay (K2).

NOTE
 External accessories are disconnected.

Caution
 No hot water is produced when emergency mode is activated.

The emergency mode relay can be used to activate external additional heat, an external thermostat must then be connected to the control circuit to control the temperature. Ensure that the heating medium circulates through the external additional heating.

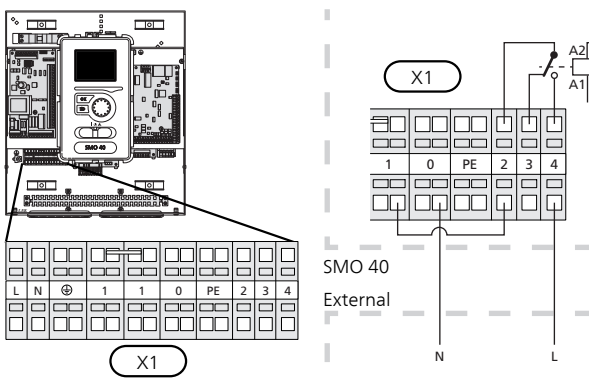
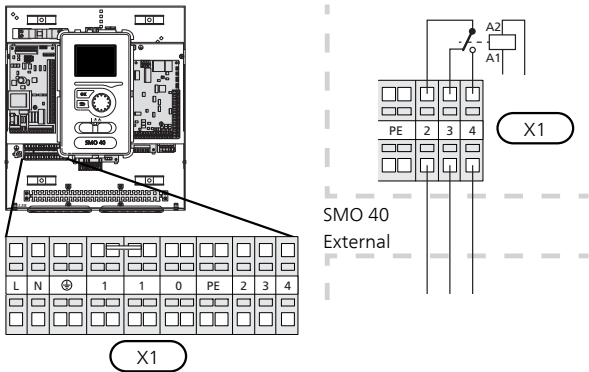

If the relay is to be used for control voltage, bridge the supply from terminal block X1:1 to X1:2 and connect neutral and control voltage from the external additional heat to X1:0 (N) and X1:4 (L).

External circulation pump

Connect the external circulation pump (GP10) as illustrated to terminal block X4:9 (PE), X4:10 (N) and X4:11 (230 V) on the base board (AA2).

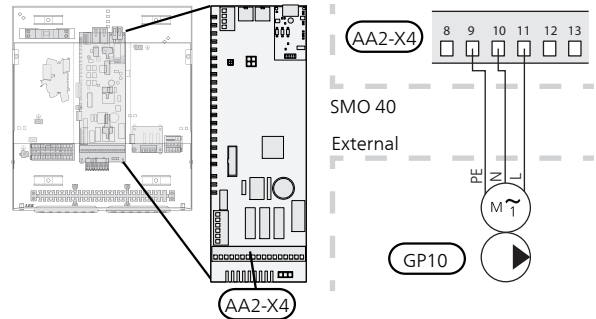

Shuttle valve

SMO 40 can be supplemented with an external reversing valve (QN10) for hot water control (see page 55 for accessory).

Hot water production can be selected in menu 5.2.4.

Connect the external reversing valve (QN10) as illustrated to terminal block X4:2 (N), X4:3 (control) and X4:4 (L) on the base board (AA2).

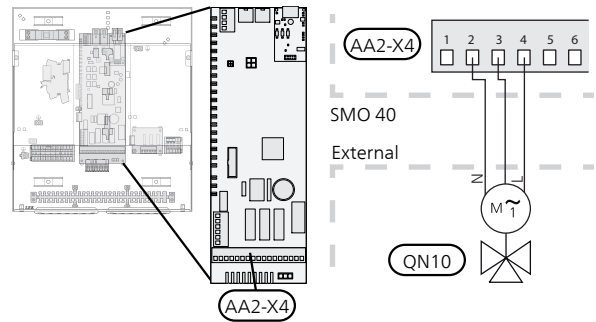

NIBE Uplink™

Connect the network connected cable (straight, Cat.5e UTP) with RJ45-contact (male) to contact AA4-X9 on the display unit (as illustrated). Use the cable grommet (UB2) in the control module for cable routing.

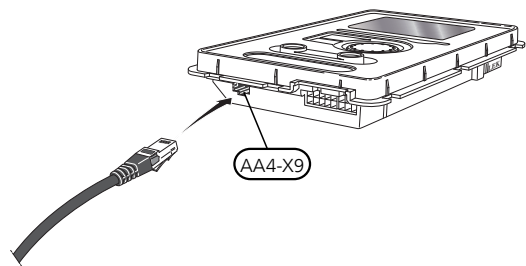

External connection options

On terminal block (X6) on the input card AA3) and terminal block X2, SMO 40 has software controlled inputs and outputs for connection of sensors and external switch function. This means that a sensor or an external switch function can be connected to one of six special connections where the function for connection is decided in the control module software.



Caution

If an external contact function is connected to SMO 40, the function for use input or output must be selected in menu 5.4.

Selectable inputs on the input card (AA3) for these functions are AUX1 (X6:9-10), AUX2 (X6:11-12) and AUX3 (X6:13-14). On terminal block X2 there are the following selectable inputs AUX4 (X2:1), AUX5 (X2:2) and AUX6 (X2:3). Earth for AUX4 to 6 is connected to terminal block X2:4.

Selectable output is terminal block X7 on input card (AA3).

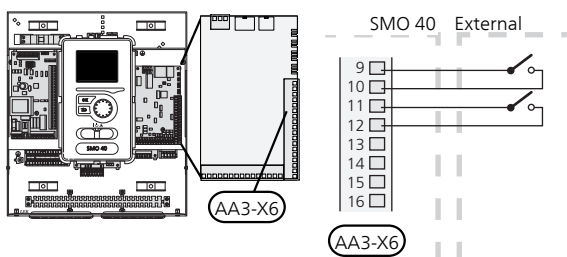
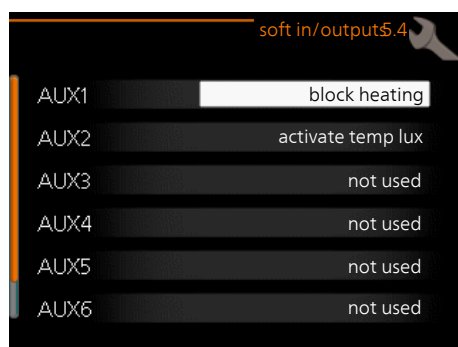

The example above uses the inputs AUX1 (X6:9-10) and AUX2 (X6:11-12) on the input circuit board (AA3).



Caution

Some of the following functions can also be activated and scheduled via menu settings.

Possible selection for AUX inputs

Following functions can be connected to the AUX inputs on input board (AA3) or terminal block X2.

These functions are then selected in menu 5.4. Use a 2 core cable of at least 0.5 mm² cable area.

Temperature sensor, cooling/heating

If a particular room will determine how the whole installation will work, a room sensor ((BT74) is used. If room sensor (BT74) is connected to SMO 40, room

sensor (BT74) determines when it is time to switch between cooling and heating operation for the whole installation.

The alternative only applies if accessories for cooling are present or if the heat pump has the integrated cooling function.

Temperature sensor, external supply at additional heat before reversing valve (QN10)

A temperature sensor, supply line after additional heating (BT63) can be connected to SMO 40 to measure the temperature after the additional heating.

Temperature sensor, flow line cooling

In cases where the active cooling 4 pipe system function is used on the AUX output, a temperature sensor supply line cooling (BT64) must be connected to SMO 40. The alternative is only shown if the cooling function in the heat pump has been activated.



NOTE

If the accessories card is used for cooling function, the sensor is connected there.

Temperature sensor, boiler

A temperature sensor, boiler (BT52) can be connected to SMO 40. The alternative is only shown if shunt controlled additional heat is selected in menu 5.1.12.

Contact for external tariff blocking

In those cases where external tariff blocking is desired, this can be connected to the input card (AA3) or terminal block X2.

Tariff blocking means that the additional heat, the compressor, heating and cooling are disconnected by connecting a potential free switch function to the input selected in menu 5.4.

A closed contact results in the electrical output being disconnected.

Switch for "SG ready"



NOTE

This function can only be used in mains networks that support the "SG Ready"-standard

"SG Ready" requires two AUX inputs.

In cases where this function is required it must be connected to terminal block X6 on the input board (AA3) or terminal block X2.

"SG Ready" is a smart form of tariff control where your electricity supplier can affect the indoor, hot water and/or pool temperatures (if applicable) or simply block the additional heat and/or compressor in the heat pump at certain times of the day (can be selected in menu 4.1.5 after the function is activated). Activate the function by connecting potential-free switch functions to two inputs selected in menu 5.4 (SG Ready A and SG Ready B), see page 47.

Closed or open switch means one of the following:

■ **Blocking (A: Closed, B: Open)**

"SG Ready" is active. The compressor in the heat pump and additional heat is blocked like the day's tariff blocking.

■ **Normal mode (A: Open, B: Open)**

"SG Ready" is not active. No effect on the system.

■ **Low price mode (A: Open, B: Closed)**

"SG Ready" is active. The system focuses on costs savings and can for example exploit a low tariff from the electricity supplier or over-capacity from any own power source (effect on the system can be adjusted in the menu 4.1.5).

■ **Overcapacity mode (A: Closed, B: Closed)**

"SG Ready" is active. The system is permitted to run at full capacity at over capacity (very low price) with the electricity supplier (effect on the system is settable in menu 4.1.5).

(A = SG Ready A and B = SG Ready B)

■ **Contact for activation of "temporary lux"**

An external switch function can be connected to SMO 40 for activation of the hot water function "temporary lux". The contact must be potential free and connected to the selected input (menu 5.4) on the input card (AA3) or on terminal block (X2).

"temporary lux" is activated for the time that the contact is connected.

■ **Contact for activation of "external adjustment"**

An external contact function can be connected to SMO 40 to change the supply temperature and the room temperature.

When the switch is closed the temperature changes in °C (if the room sensor is connected and activated). If a room sensor is not connected or activated, the desired change of "temperature" (heating curve offset) with the number of steps selected is set. The value is adjustable between -10 and +10.

■ *climate system 1*

The contact must be potential-free and connected to the selected input (menu 5.4) on the input board (AA3) or on terminal block (X2).

The value for the change is set in menu 1.9.2, "external adjustment".

■ *climate system 2 to 8*

External adjustment for climate systems 2 to 8 requires accessories (ECS 40 or ECS 41).

See the accessory's installer handbook for installation instructions.

■ **Switch for external alarm**

Alarms from external devices can be connected to the control and appear as an info alarm. Potential-free signal of NO or NC type can be connected.

Switch for external blocking of

In cases where external blocking of the function is desired, this can be connected to the input board (AA3) or terminal block X2.

The function is disconnected by connecting a potential-free switch function to the input selected in menu 5.4.

A closed contact results in the function being disconnected.

Functions that can be blocked:

- addition
- compressor in heat pump EB101 and/or EB102
- heating
- cooling
- hot water

Possible selection for AUX output (potential free variable relay)

It is possible to have an external connection through the relay function via a potential-free variable relay (max 2 A at resistive load) on terminal block X7 on the input board (AA3).

Optional functions for external connection:

- Indication of buzzer alarm. The function gives signals whilst a constant alarm is indicated by the control module.
- Cooling mode indication. This option requires activation of some form of cooling function. The function gives signals when the system permits cooling and can be used to control external pumps for example.
- Active cooling (4 pipe) This option requires activation of some form of cooling function and can be used for simple 4-pipe systems (an outdoor unit). The function gives signals when a connected heat pump produces cooling and there are no other demands and cooling is permitted. This function can be used to control reversing valve for cooling EP25-QN12.



Caution

With this option, the charge pump (GP12) is always controlled in "auto" operating mode, which means that the pump is running when the reversing valve (QN12) is towards the cooling system.

- External heating medium pump. The function gives signals when an external circulation pump (GP10) is to be operated according to settings for the operating mode.
- Control of circulation pump for hot water circulation. The function gives signals when a circulation pump for hot water circulation (GP11) is to be operated according to settings in menu "hot water recirc." (2.9.2).

If any of the above is installed to terminal block X7 on input board (AA3) the function must be selected in menu 5.4

The common alarm is preselected at the factory.



NOTE

An accessory board is required, if several functions are connected to terminal block X7 at the same time the common alarm is activated (see page 55).

When switch (SF1) is in the "⏏" or "⚠" position the relay is in the alarm position.

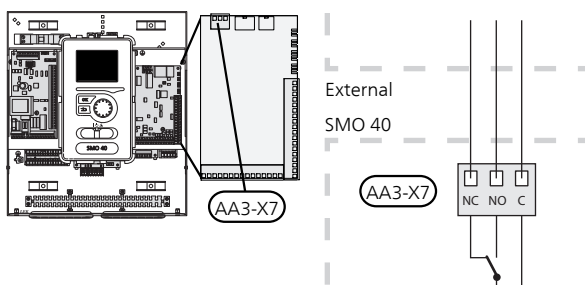

The picture shows the relay in the alarm position.

Hot water circulation pump or external heating medium pump connected to the buzzer alarm relay as illustrated below.

NOTE
 Mark up any junction boxes with warnings for external voltage.

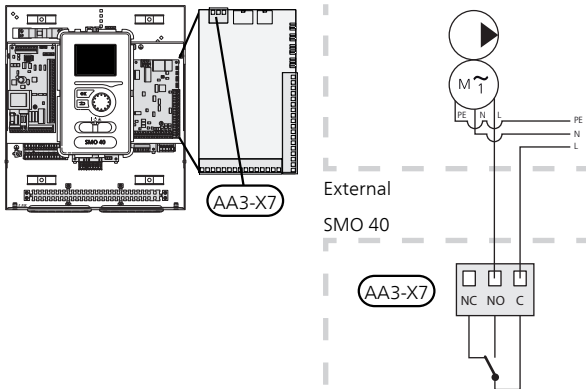

Reversing valve for cooling connected to the buzzer alarm relay as illustrated below.

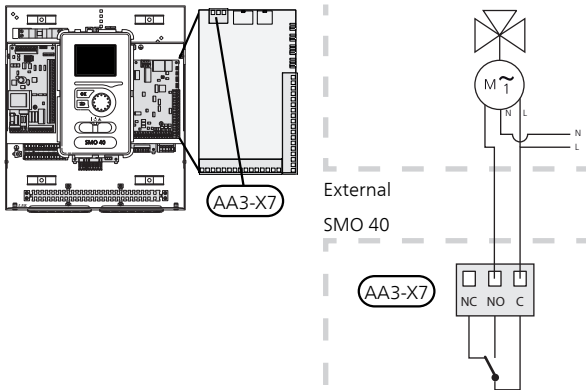

Caution
 The relay outputs can have a max load of 2 A at resistive load (230V AC).

Connecting accessories

Instructions for connecting other accessories are in the installation instructions provided. See page 55 for the list of the accessories that can be used with SMO 40.

6 Commissioning and adjusting

Preparations

- Compatible NIBE air/water heat pump must be equipped with a control card that has at least the software version as listed on page 9. The control card version is displayed in the heat pump's display (if applicable) upon start-up.
- SMO 40 must be ready-connected.
- The climate system must be filled with water and bled.

Commissioning with NIBE air/water heat pump

NIBE F2015/F2020/F2025

- Follow the instructions in the heat pump's Installation and Maintenance under section "Commissioning and adjustment" – "Start-up and inspection".

NIBE F2016/F2026/F2030/F2040/F2300

- Follow the instructions in the heat pump's Installation manual under section "Commissioning and adjustment" – "Start-up and inspection".

SMO 40

1. Power the heat pump.
2. Power SMO 40.
3. Follow the start guide in the display on SMO 40 alternatively start the start guide in menu 5.7.

Commissioning with additional heating only

At first start follow the start guide, otherwise follow the list below.

1. Go to menu 4.2 op. mode.
2. Mark "add. heat only" using the control knob and then press the OK button.
3. Return to the main menus by pressing the Back button.



Caution

When commissioning without NIBE air/water heat pump an alarm communication error may appear in the display.

The alarm is reset if the relevant heat pump is deactivated in menu 5.2.2 ("installed slaves").

Check the reversing valve

1. Activate "AA2-K1 (QN10)" in menu 5.6.
2. Check that the reversing valve opens or is open for hot water charging.
3. Deactivate "AA2-K1 (QN10)" in menu 5.6.

Check AUX socket

To check any function connected to the AUX socket

1. Activate "AA3-X7" in menu 5.6.
2. Check the desired function.
3. Deactivate "AA3-X7" in menu 5.6.

Cooling mode

If the installation contains one or several NIBE air/water heat pumps that can produce cooling (for example NIBE F2040) cooling can be permitted in the relevant sub-menu for menu 5.11.

You can now select cooling mode indication in menu 5.4 for AUX output.

Start guide



NOTE

There must be water in the climate system before the switch is set to "I".

1. Set the control module's switch () to "I".
2. Follow the instructions in the start guide in the control module display. If the start guide does not start when you start the control module, start it manually in menu 5.7.



TIP

See page 34 for a more in-depth introduction to the installation's control system (operation, menus etc.).

Commissioning

The first time the installation is started a start guide is started. The start guide instructions state what needs to be carried out at the first start together with a run through of the installation's basic settings.

The start guide ensures that the start-up is carried out correctly and cannot be bypassed. The start guide can be started later in menu 5.7.

This applies to a heat pump with approximately 4 kW rated output.

For a 15 kW heat pump the corresponding flow is from 0.09 l/s (324 l/h) to 0.14 l/s (504 l/h).

During the start-up guide, the reversing valves and the shunt are run back and forth to help vent the heat pump.



Caution

As long as the start guide is active, no function in the heat pump will start automatically.

The guide will appear at each heat pump re-start until it is deselected on the last page.

Operation in the start guide

A. Page

B. Name and menu number

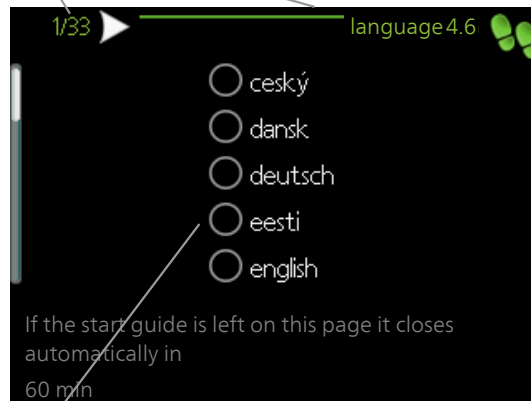

C. Option / setting

A. Page

Here you can see how far you have come in the start guide.

Scroll between the pages of the start guide as follows:

1. Turn the control knob until one of the arrows in the top left corner (at the page number) has been marked.
2. Press the OK button to skip between the pages in the start guide.

B. Name and menu number

Read what menu in the control system this page of the start guide is based on. The digits in brackets refer to the menu number in the control system.

If you want to read more about affected menus either consult the help menu or read the user manual.

C. Option / setting

Make settings for the system here.

D. Help menu



In many menus there is a symbol that indicates that extra help is available.

To access the help text:

1. Use the control knob to select the help symbol.
2. Press the OK button.

The help text often consists of several windows that you can scroll between using the control knob.

Setting the cooling/heating curve

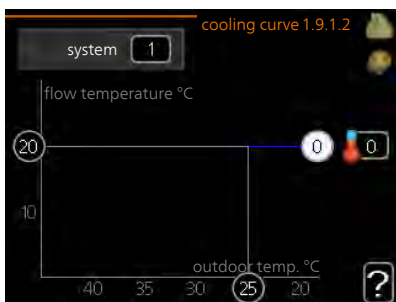
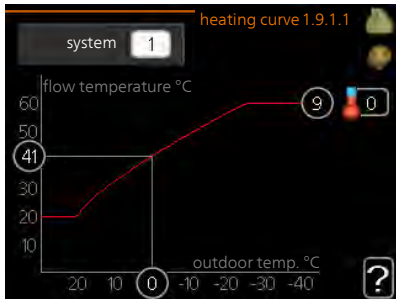

heating curve

Setting range: 0 - 15

Default value: 9

cooling curve (accessory required)

Setting range: 0 - 9

Default value: 0

The prescribed heating curve for your house can be viewed in the menu **heating curve**. The task of the heating curve is to give an even indoor temperature, regardless of the outdoor temperature, and thereby energy efficient operation. It is from this heating curve that the control module's control computer determines the temperature of the water to the heating system, supply temperature, and therefore the indoor temperature. Select the heating curve and read off how the supply temperature changes at different outdoor temperatures here. If there is access to cooling the same settings can be made for the cooling curve.

Curve coefficient

The slopes of the heating /cooling curves indicate how many degrees the supply temperature is to be increased/reduced when the outdoor temperature drops/increases. A steeper slope means a higher supply temperature for heating or a lower supply temperature for cooling at a certain outdoor temperature.

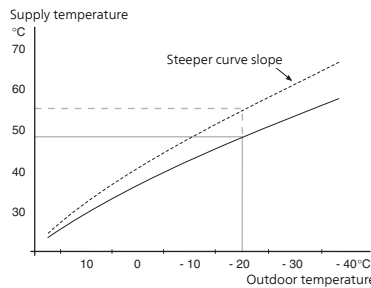

The optimum slope depends on the climate conditions in your location, if the house has radiators or under floor heating and how well insulated the house is.

The curve is set when the heating installation is installed, but may need adjusting later. Normally, the curve will not need further adjustment.



Caution

In the event of making fine adjustments of the indoor temperature, the curve must be offset up or down instead, this is done in menu 1.1 **temperature**.

Curve offset

An offset of the curve means that the supply temperature changes as much for all the outdoor temperatures, e.g. that a curve offset of +2 steps increases the supply temperature by 5 °C at all outdoor temperatures.

Flow line temperature– maximum and minimum values

Because the flow line temperature cannot be calculated higher than the set maximum value or lower than the set minimum value the heating curve flattens out at these temperatures.



Caution

Underfloor heating systems are normally **max flow line temperature** set between 35 and 45 °C.

Must be restricted with underfloor cooling min. flow line temp. to prevent condensation.

Check the max temperature for your floor with your installer/floor supplier.

The figure at the end of the curve indicates the curve slope. The figure beside the thermometer gives the curve offset. Use the control knob to set a new value. Confirm the new setting by pressing the OK button.

Curve 0 is an own curve created in menu 1.9.7.

To select another curve (slope):



NOTE

If you only have one climate system, the number of the curve is already marked when the menu window opens.

1. Select the climate system (if more than one) for which the curve is to be changed.
2. When the climate system selection has been confirmed, the curve number is marked.

3. Press the OK button to access the setting mode
4. Select a new curve. The curves are numbered from 0 to 15, the greater the number, the steeper the slope and the greater the supply temperature. Curve 0 means that **own curve** (menu 1.9.7) is used.
5. Press the OK button to exit the setting.

To read off a curve:

1. Turn the control knob so that the ring on the shaft with the outdoor temperature is marked.
2. Press the OK button.
3. Follow the grey line up to the curve and out to the left to read off the value for the supply temperature at the selected outdoor temperature.
4. You can now select to take read outs for different outdoor temperatures by turning the control knob to the right or left and read off the corresponding flow temperature.
5. Press the OK or Back button to exit read off mode.



TIP

Wait 24 hours before making a new setting, so that the room temperature has time to stabilise.

If it is cold outdoors and the room temperature is too low, increase the curve slope by one increment.

If it is cold outdoors and the room temperature is too high, lower the curve slope by one increment.

If it is warm outdoors and the room temperature is too low, increase the curve offset by one increment.

If it is warm outdoors and the room temperature is too high, lower the curve offset by one increment.

Setting hot water circulation

hot water recirc. (accessory required)

operating time

Setting range: 1 - 60 min

Default value: 60 min

downtime

Setting range: 0 - 60 min

Default value: 0 min

Set the hot water circulation for up to three periods per day here. During the set periods the hot water circulation pump will run according to the settings above.

"operating time" decide how long the hot water circulation pump must run per operating instance.

"downtime" decide how long the hot water circulation pump must be stationary between operating instances.

Hot water circulation is activated in menu 5.4 "soft inputs and outputs".

Pool

pool 1 - pool 2 (accessory is required)

start temp

Setting range: 5.0 - 80.0 °C

Default value: 22.0 °C

stop temperature

Setting range: 5.0 - 80.0 °C

Default value: 24.0 °C

maximum number of compr.

Setting range: 1 – 8

Factory setting: 8

Select whether the pool control is to be activated, within what temperatures (start and stop temperature) pool heating must occur and how many compressors may work against the pool at the same time.

Maximum number gives the possibility of restricting the number of compressors that are permitted to work with pool heating. The setting can be adjusted if requirements other than pool heating must be prioritised for example.

When the pool temperature drops below the set start temperature and there is no hot water or heating requirement, SMO 40 starts pool heating.

Untick "activated" to switch off the pool heating.



Caution

The start temperature cannot be set to a value that is higher than the stop temperature.

SG Ready

SG Ready

This function can only be used in mains networks that support the "SG Ready"-standard .

Make settings for the function "SG Ready" here.

Low price mode means that the electricity supplier has a low tariff and the system uses this to reduce costs.

Over capacity mode means that the electricity supplier has set the tariff very low and the system uses this to reduce the costs as much as possible.

affect room temperature

Here you set whether room temperature should be affected when activating "SG Ready".

With low price mode of "SG Ready" the parallel offset of the indoor temperature is increased by "+1". If a room sensor is installed and activated, the desired room temperature increases by 1 °C.

With over capacity mode of "SG Ready" the parallel offset for the indoor temperature is increased by "+2". If a room sensor is installed and activated, the desired room temperature increases by 2 °C.

affect hot water

Here you set whether the temperature of the hot water should be affected when activating "SG Ready".

With low price mode on "SG Ready" the stop temperature of the hot water is set as high as possible at only compressor operation (immersion heater not permitted).

With over capacity mode of "SG Ready" the hot water is set to "luxury" (immersion heater permitted).

affect cooling (accessory required)

Here you set whether room temperature during cooling operation should be affected when activating "SG Ready".

With low price mode of "SG Ready" and cooling operation the indoor temperature is not affected.

With over capacity mode of "SG Ready" and cooling operation the parallel offset for the indoor temperature is reduced by "-1". If a room sensor is installed and activated, the desired room temperature decreases by 1 °C.

affect pool temperature (accessory is required)

Here you set whether pool temperature should be affected when activating "SG Ready".

With low price mode on "SG Ready", the desired pool temperature (start and stop temperature) is increased by 1 °C.

With over capacity mode of "SG Ready", the desired pool temperature (start and stop temperature) is increased by 2 °C.



NOTE

The function must be connected to two AUX inputs and activated in menu 5.4.

7 Control - Introduction

Display unit

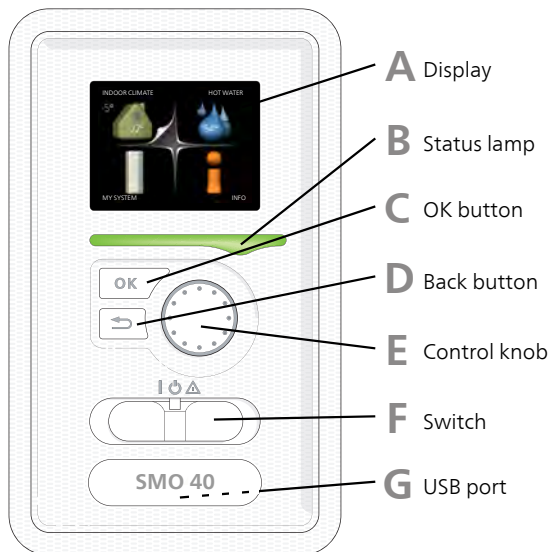

A Display

Instructions, settings and operational information are shown on the display. The easy-to-read display and menu system, facilitates navigation between the different menus and options to set the comfort or obtain the information you require.

B Status lamp

The status lamp indicates the status of the control module. It:

- lights green during normal operation.
- lights yellow in emergency mode.
- lights red in the event of a deployed alarm.

C OK button

The OK button is used to:

- confirm selections of sub menus/options/set values/page in the start guide.

D Back button

The back button is used to:

- go back to the previous menu.
- change a setting that has not been confirmed.

E Control knob

The control knob can be turned to the right or left. You can:

- scroll in menus and between options.
- increase and decrease the values.
- change page in multiple page instructions (for example help text and service info).

F Switch (SF1)

The switch assumes three positions:

- On (I)
- Standby (⏻)
- Emergency mode (⚠)

Emergency mode must only be used in the event of a fault on the control module. In this mode, the compressor in the heat pump switches off and the immersion heater engages. The control module display is not illuminated and the status lamp illuminates yellow.

G USB port

The USB port is hidden beneath the plastic badge with the product name on it.

The USB port is used to update the software. Visit <http://www.nibeuplink.com> and click the "Software" tab to download the latest software for your installation.

Menu system

When the door to the control module is opened, the menu system's four main menus are shown in the display as well as certain basic information.

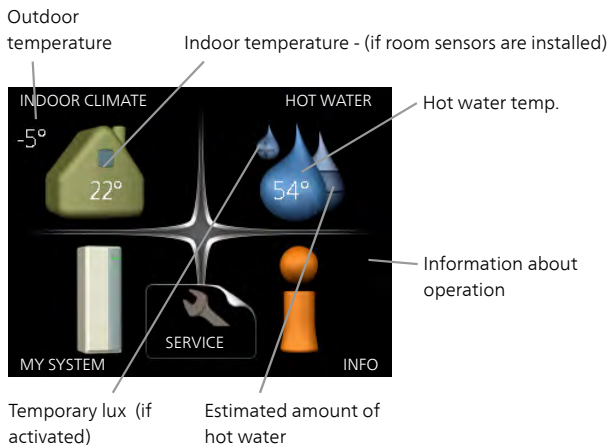

Menu 1 - INDOOR CLIMATE

Setting and scheduling the indoor climate. See information in the help menu or user manual.

Menu 2 - HOT WATER

Setting and scheduling hot water production. See information in the help menu or user manual.

This menu only appears if a water heater is installed in the system.

Menu 3 - INFO

Display of temperature and other operating information and access to the alarm log. See information in the help menu or user manual.

Menu 4 - MY SYSTEM

Setting time, date, language, display, operating mode etc. See information in the help menu or user manual.

Menu 5 - SERVICE

Advanced settings. These settings are not available to the end user. The menu is made visible by pressing the Back button for 7 seconds when in the start menu. See page 41.

Symbols in the display

The following symbols can appear in the display during operation.

Symbol	Description
	This symbol appears by the information sign if there is information in menu 3.1 that you should note.
	These two symbols indicate whether the compressor in the outdoor unit or additional heat in the installation is blocked via SMO 40. These can, for example, be blocked depending on which operating mode is selected in menu 4.2, if blocking is scheduled in menu 4.9.5 or if an alarm has occurred that blocks one of them. Blocking the compressor. Blocking additional heat.
	This symbol appears if periodic increase or lux mode for the hot water is activated.
	This symbol indicates whether "holiday setting" is active in 4.7.
	This symbol indicates whether SMO 40 has contact with NIBE Uplink™.
	This symbol indicates whether solar heating is active. Accessory needed.
	This symbol indicates whether pool heating is active. Accessory needed.
	This symbol indicates whether cooling is active. Heat pump with cooling function required.

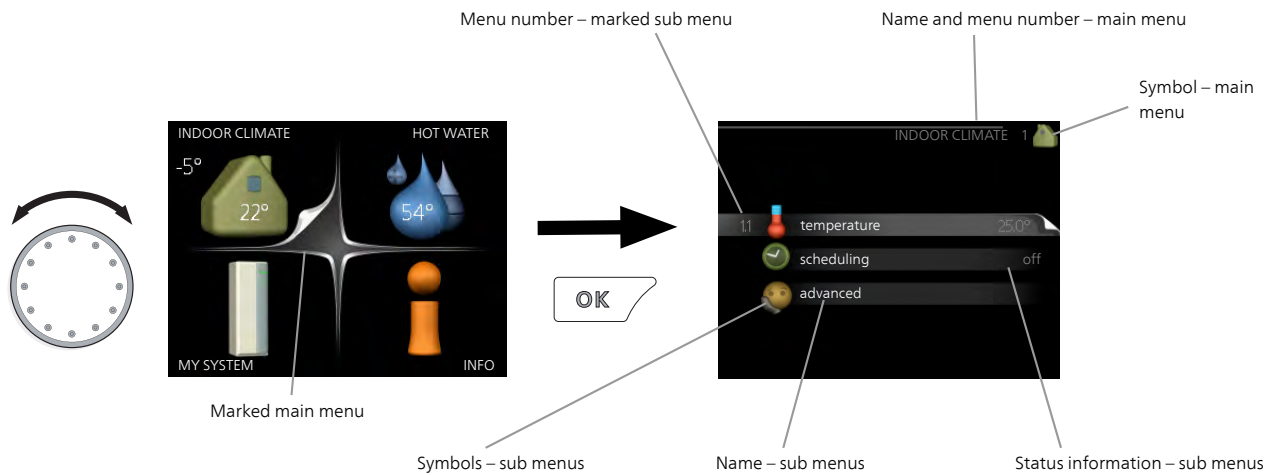

Operation

To move the cursor, turn the control knob to the left or the right. The marked position is white and/or has a turned up tab.



Selecting menu

To advance in the menu system select a main menu by marking it and then pressing the OK button. A new window then opens with sub menus.

Select one of the sub menus by marking it and then pressing the OK button.

Selecting options



Alternative

In an options menu the current selected option is indicated by a green tick.

To select another option:

1. Mark the applicable option. One of the options is pre-selected (white).
2. Press the OK button to confirm the selected option. The selected option has a green tick.

Setting a value



Values to be changed

To set a value:

1. Mark the value you want to set using the control knob.
2. Press the OK button. The background of the value becomes green, which means that you have accessed the setting mode.
3. Turn the control knob to the right to increase the value and to the left to reduce the value.
4. Press the OK button to confirm the value you have set. To change and return to the original value, press the Back button.

Use the virtual keyboard

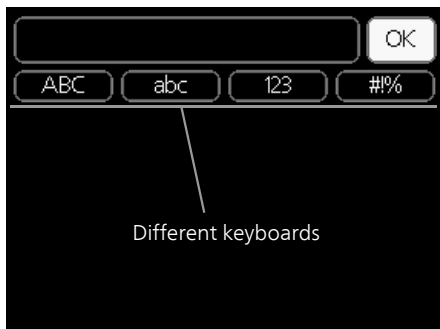

In some menus where text may require entering, a virtual keyboard is available.

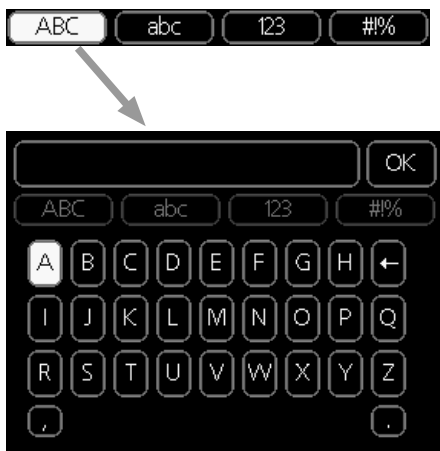

Depending on the menu, you can gain access to different character sets which you can select using the control knob. To change character table, press the Back button. If a menu only has one character set the keyboard is displayed directly.

When you have finished writing, mark "OK" and press the OK button.

Scroll through the windows

A menu can consist of several windows. Turn the control knob to scroll between the windows.

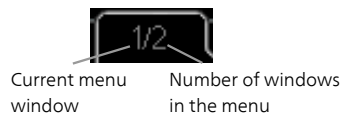

Scroll through the windows in the start guide



Arrows to scroll through window in start guide

1. Turn the control knob until one of the arrows in the top left corner (at the page number) has been marked.
2. Press the OK button to skip between the steps in the start guide.

Help menu

 In many menus there is a symbol that indicates that extra help is available.

To access the help text:

1. Use the control knob to select the help symbol.
2. Press the OK button.

The help text often consists of several windows that you can scroll between using the control knob.

8 Control

Menu 1 - INDOOR CLIMATE

1 - INDOOR CLIMATE	1.1 - temperature	1.1.1 - heating	
		1.1.2 - cooling *	
	1.3 - scheduling	1.3.1 - heating	
		1.3.2 - cooling *	
	1.9 - advanced	1.9.1 - curve	1.9.1.1 heating curve
			1.9.1.2 - cooling curve *
		1.9.2 - external adjustment	
		1.9.3 - min. flow line temp.	1.9.3.1 - heating
			1.9.3.2 - cooling *
		1.9.4 - room sensor settings	
		1.9.5 - cooling settings *	
		1.9.7 - own curve	1.9.7.1 - heating
			1.9.7.2 - cooling *
		1.9.8 - point offset	

* Heat pump with cooling function required.

Menu 2 - HOT WATER

2 - HOT WATER	2.1 - temporary lux	
	2.2 - comfort mode	
	2.3 - scheduling	
	2.9 - advanced	2.9.1 - periodic increase
		2.9.2 - hot water recirc. *

Menu 3 - INFO

3 - INFO	3.1 - service info
	3.2 - compressor info
	3.3 - add. heat info
	3.4 - alarm log
	3.5 - indoor temp. log

* Accessories are needed.

Menu 4 - MY SYSTEM

4 - MY SYSTEM	4.1 - plus functions	4.1.1 - pool *
		4.1.2 - pool 2 *
		4.1.3 - internet
		4.1.3.1 - nibe uplink
		4.1.3.8 - tcp/ip settings
		4.1.3.9 - proxy settings
		4.1.4 - sms *
		4.1.5 - SG Ready
		4.1.6 - smart price adaption
	4.2 - op. mode	
	4.3 - my icons	
	4.4 - time & date	
	4.6 - language	
	4.7 - holiday setting	
	4.9 - advanced	4.9.1 - op. prioritisation
		4.9.2 - auto mode setting
		4.9.3 - degree minute setting
		4.9.4 - factory setting user
		4.9.5 - schedule blocking
		4.9.6 - schedule silent mode

* Accessories are needed.

Menu 5 - SERVICE

Overview

5 - SERVICE	5.1 - operating settings	5.1.1 - hot water settings *	
		5.1.2 - max flow line temperature	
		5.1.3 - max diff flow line temp.	
		5.1.4 - alarm actions	
		5.1.12 - addition	
		5.1.14 - flow set. climate system	
		5.1.22 - heat pump testing	
		5.1.23 - compressor curve	
	5.2 - system settings	5.2.2 - installed slaves	
		5.2.3 - docking	
		5.2.4 - accessories	
	5.3 - accessory settings	5.3.2 - shunt controlled add. heat *	
		5.3.3 - extra climate system *	
		5.3.4 - solar heating *	
		5.3.6 - step controlled add. heat	
		5.3.8 - hot water comfort *	
		5.3.20 - Flow sensor	
	5.4 - soft in/outputs		
	5.5 - factory setting service		
	5.6 - forced control		
	5.7 - start guide		
	5.8 - quick start		
	5.9 - floor drying function		
	5.10 - change log		
	5.11 - slave settings	5.11.1 - EB101	5.11.1.1 - heat pump
			5.11.1.2 - charge pump (GP12)
		5.11.2 - EB102	
		5.11.3 - EB103	
		5.11.4 - EB104	
		5.11.5 - EB105	
		5.11.6 - EB106	
		5.11.7 - EB107	
		5.11.8 - EB108	
	5.12 - country		

* Accessory needed.

Go to the main menu and hold the Back button in for 7 seconds to access the Service menu.

Sub-menus

Menu **SERVICE** has orange text and is intended for the advanced user. This menu has several sub-menus. Status information for the relevant menu can be found on the display to the right of the menus.

operating settings Operating settings for the control module.

system settings System settings for the control module, activating accessories etc.

accessory settings Operational settings for different accessories.

soft in/outputs Setting software controlled in and outputs on the input card (AA3) and terminal block (X2).

factory setting service Total reset of all settings (including settings available to the user) to default values.

forced control Forced control of the different components in the indoor module.

start guide Manual start of the start guide which is run the first time when the control module is started.

quick start Quick starting the compressor.



NOTE

Incorrect settings in the service menus can damage the installation.

Menu 5.1 - operating settings

Operating settings can be made for the control module in the sub menus.

Menu 5.1.1 - hot water settings

economy

Setting range start temp. economy: 5 – 55 °C

Factory setting start temp. economy: 42 °C

Setting range stop temp. economy: 5 – 60 °C

Factory setting stop temp. economy: 48 °C

normal

Setting range start temp. normal: 5 – 60 °C

Factory setting start temp. normal: 46 °C

Setting range stop temp. normal: 5 – 65 °C

Factory setting stop temp. normal: 50 °C

luxury

Setting range start temp. lux: 5 – 70 °C

Factory setting start temp. lux: 49 °C

Setting range stop temp. lux: 5 – 70 °C

Factory setting stop temp. lux: 53 °C

stop temp. per. increase

Setting range: 55 – 70 °C

Factory setting: 55 °C

step difference compressors

Setting range: 0.5 – 4.0 °C

Factory setting: 1.0 °C

charge method

Setting range: target temp, delta temp

Default value: delta temp

Here you set the start and stop temperature of the hot water for the different comfort options in menu 2.2 as well as the stop temperature for periodic increase in menu 2.9.1.

The charge method for hot water mode is selected here. "delta temp" is recommended for heaters with charge coil, "target temp" for heaters with domestic coil.

Menu 5.1.2 - max flow line temperature

climate system

Setting range: 5-70 °C

Default value: 60 °C

Set the maximum supply temperature for the climate system here. If the installation has more than one climate system, individual maximum supply temperatures can be set for each system. Climate systems 2 - 8 cannot be set to a higher max supply temperature than climate system 1.



Caution

Underfloor heating systems are normally **max flow line temperature** set between 35 and 45 °C.

Check the max floor temperature with your floor supplier.

Menu 5.1.3 - max diff flow line temp.

max diff compressor

Setting range: 1 – 25 °C

Default value: 10 °C

max diff addition

Setting range: 1 – 24 °C

Default value: 7 °C

Here you set the maximum permitted difference between the calculated and actual supply temperature during compressor respectively add. heat mode. Max diff. additional heat can never exceed max diff. compressor

max diff compressor

When the current supply temperature **deviates** from the set value compared to that calculated, the heat pump is forced to stop irrespective of the degree-minute value.

If the current supply temperature **exceeds** the calculated flow with set value, the degree minute value is set to 0. The compressor in the heat pump stops when there is only a heating demand.

max diff addition

If "addition" is selected and activated in menu 4.2 and the present supply temp **exceeds** the calculated with set value, the additional heat is forced to stop.

Menu 5.1.4 - alarm actions

Select how you want the control module to alert you that there is an alarm in the display here. The different alternatives are; the heat pump stops producing hot water and/or reduces the room temperature.



Caution

If no alarm action is selected, it can result in higher energy consumption in the event of an alarm.

Menu 5.1.12 - addition

Make settings for connected additional heat (step controlled or shunt controlled additional heat) here.

Select whether step controlled or shunt controlled additional heat is connected. Then you can make settings for the different alternatives.

add.type: step controlled

max step

Setting range (binary stepping deactivated): 0 – 3

Setting range (binary stepping activated): 0 – 7

Default value: 3

fuse size

Setting range: 1 - 200 A

Factory setting: 16 A

transformation ratio

Setting range: 300 - 3000

Factory setting: 300

Select this option if the step controlled additional heat is connected and is positioned before or after the reversing valve for hot water charging (QN10). Step controlled additional heat is for example an external electric boiler.

When binary stepping is deactivated (off), the settings refer to linear stepping.

Here you can set the maximum number of permitted additional heat steps, if there is internal additional heat in the tank (only accessible if the additional heat is positioned after QN10), whether binary stepping is to be used, the size of the fuse and transformer ratio.

add.type: shunt controlled

prioritised additional heat

Setting range: on/off

Factory setting: off

minimum running time

Setting range: 0 – 48 h

Default value: 12 h

min temp.

Setting range: 5 – 90 °C

Default value: 55 °C

mixing valve amplifier

Setting range: 0.1 – 10.0

Default value: 1.0

mixing valve step delay

Setting range: 10 – 300 s

Default values: 30 s

fuse size

Setting range: 1 - 200 A

Factory setting: 16 A

transformation ratio

Setting range: 300 - 3000

Factory setting: 300

Select this option if shunt controlled additional heat is connected.

Set when the addition is to start, the minimum run time and the minimum temperature for external addition with shunt here. External addition with shunt is for example a wood/oil/gas/pellet boiler.

You can set shunt valve amplification and shunt valve waiting time.

Selecting "prioritised additional heat" uses the heat from the external additional heat instead of the heat pump. The shunt valve is regulated as long as heat is available, otherwise the shunt valve is closed.



TIP

See the accessory installation instructions for function description.

Menu 5.1.14 - flow set. climate system

presettings

Setting range: radiator, floor heat., rad. + floor heat., DOT °C

Default value: radiator

Setting range DOT: -40.0 – 20.0 °C

The factory setting of DOT value depends on the country that has been given for the product's location. The example below refers to Sweden.

Factory setting DOT: -20.0 °C

own setting

Setting range dT at DOT: 0.0 – 25.0

Factory setting dT at DOT: 10.0

Setting range DOT: -40.0 – 20.0 °C

Factory setting DOT: -20.0 °C

The type of heating distribution system the heating medium pump works towards is set here.

dT at DOT is the difference in degrees between flow and return temperatures at dimensioned outdoor temperature.

Menu 5.1.22 - heat pump testing



NOTE

This menu is intended for testing SMO 40 according to different standards.

Use of this menu for other reasons may result in your installation not functioning as intended.

This menu contains several sub-menus, one for each standard.

Menu 5.1.23 - compressor curve

Set whether the compressor in the heat pump should work to a particular curve under specific requirements or if it should work to predefined curves.

You set a curve for a demand (heat, hot water etc.) by unticking "auto", turning the control knob until a temperature is marked and pressing OK. You can now set at what temperatures the max. and min. frequencies, respectively will occur.

This menu can consist of several windows (one for each available demand), use the navigation arrows in the top left corner to change between the windows.



NOTE

This menu is only displayed if SMO 40 is connected to a heat pump with inverter controlled compressor.

Menu 5.2 - system settings

Make different system settings for your installation here, e.g. activate connected slaves and which accessories are installed.

Menu 5.2.2 - installed slaves

If a slave is connected to the master installation, set it here.

There are two ways of activating connected slaves. You can either mark the alternative in the list or use the automatic function "search installed slaves".

search installed slaves

Mark "search installed slaves" and press the OK button to automatically find connected slaves for the master heat pump.

Menu 5.2.3 - docking

Enter how your system is docked regarding pipes, for example to pool heating, hot water heating and heating the building.



TIP

Examples of docking alternatives can be found at www.nibe.eu.

This menu has a docking memory which means that the control system remembers how a particular reversing valve is docked and automatically enters the correct docking the next time you use the same reversing valve.

Slave (heat pump) Workspace for docking

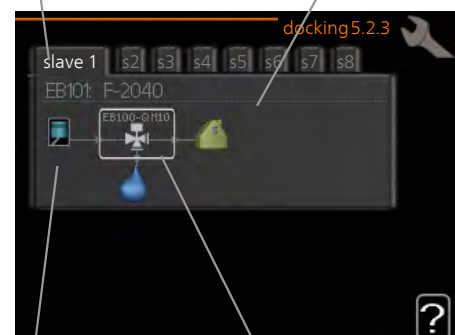

Compressor

Marking frame







Slave: Here you select the heat pump for which the docking setting is to be made.

Compressor: Select if the compressor in the heat pump is blocked (factory setting), or standard (docked for example to pool heating, hot water charging and heating the building).

Marking frame: Move around the marking frame using the control knob. Use the OK button to select what you want to change and to confirm setting in the options box that appears to the right.

Workspace for docking: The system docking is drawn here.

Symbol	Description
	Compressor (blocked)

Symbol	Description
	Compressor (standard)
	Reversing valves for hot water, cooling respectively pool control. The designations above the reversing valve indicate where it is electrically connected (EB101 = Slave 1, CL11 = Pool 1 etc.).
	Hot water charging
	Pool 1
	Pool 2
	Heating (heating the building, includes any extra climate system)
	Cooling

Menu 5.2.4 - accessories

Set which accessories are installed on the installation here.

If the water heater is connected to SMO 40 hot water charging must be activated here.

There are two ways of activating connected accessories. You can either mark the alternative in the list or use the automatic function "search installed acc."

search installed acc.

Mark "search installed acc." and press the OK button to automatically find connected accessories for SMO 40.

Menu 5.3 - accessory settings

The operating settings for accessories that are installed and activated are made in the sub-menus for this.

Menu 5.3.2 - shunt controlled add. heat

prioritised additional heat

Setting range: on/off

Factory setting: off

start diff additional heat

Setting range: 0 – 2000 GM

Default values: 400 GM

minimum running time

Setting range: 0 – 48 h

Default value: 12 h

min temp.

Setting range: 5 – 90 °C

Default value: 55 °C

mixing valve amplifier

Setting range: 0.1 – 10.0

Default value: 1.0

mixing valve step delay

Setting range: 10 – 300 s

Default values: 30 s

Set when the addition is to start, the minimum run time and the minimum temperature for external addition with shunt here. External addition with shunt is for example a wood/oil/gas/pellet boiler.

You can set shunt valve amplification and shunt valve waiting time.

Selecting "prioritised additional heat" uses the heat from the external additional heat instead of the heat pump. The shunt valve is regulated as long as heat is available, otherwise the shunt valve is closed.

See the accessory installation instructions for function description.

Menu 5.3.3 - extra climate system

use in heating mode

Setting range: on/off

Factory setting: on

use in cooling mode

Setting range: on/off

Factory setting: off

mixing valve amplifier

Setting range: 0.1 – 10.0

Default value: 1.0

mixing valve step delay

Setting range: 10 – 300 s

Default values: 30 s

Here you select which climate system (2 - 8) you wish to set. In the next menu you can make settings for the climate system that you have selected. If this function is activated, you can set "cooling flow temp. at +20°C" and "cooling flow temp. at +40°C" for each climate system where the function is activated.



Caution

This setting option only appears if "cooling permitted" is activated in menu 5.11.1.1.

The shunt amplification and shunt waiting time for the different extra climate systems that are installed are also set here.

See the accessory installation instructions for function description.

Menu 5.3.4 - solar heating

start delta-T GP4

Setting range: 1 - 40 °C

Default value: 8 °C

stop delta-T GP4

Setting range: 0 - 40 °C

Default value: 4 °C

max. tank temperature

Setting range: 5 - 110 °C

Default value: 95 °C

max. solar collector temp.

Setting range: 80 - 200 °C

Default value: 125 °C

anti-freeze temperature

Setting range: -20 - +20 °C

Default value: 2 °C

start solar collector cooling

Setting range: 80 - 200 °C

Default value: 110 °C

start delta-T, stop delta-T: Here you can set the temperature difference between solar panel and solar tank at which the circulation pump is to start and stop.

max. tank temperature, max. solar collector temp.: Here you can set the maximum temperatures in tank respectively solar panel at which the circulation pump is to stop. This is to protect against excess temperatures in the solar tank.

If the unit has an anti-freeze function and/or solar panel cooling you can activate them here. When the function has been activated, you can make settings for them.

freeze protection

anti-freeze temperature: Here you can set the temperature in the solar panel at which the circulation pump is to start to prevent freezing.

solar panel cooling

start solar collector cooling: If the temperature in the solar panel is greater than this setting at the same time that the temperature in the solar tank is greater than the set maximum temperature, the external function for cooling is activated.

See the accessory installation instructions for function description.

Menu 5.3.6 - step controlled add. heat

start addition

Setting range: 0 – 2000 GM

Default values: 400 GM

diff. between additional steps

Setting range: 0 – 1000 GM

Default values: 30 GM

max step

Setting range

(binary stepping deactivated): 0 – 3

Setting range

(binary stepping activated): 0 – 7

Default value: 3

binary stepping

Setting range: on/off

Factory setting: off

Make settings for step controlled addition here. Step controlled addition is for example an external electric boiler.

It is possible, for example, to select when the additional heat is to start, to set the maximum number of permitted steps and whether binary stepping is to be used.

When binary stepping is deactivated (off), the settings refer to linear stepping.

See the accessory installation instructions for function description.

Menu 5.3.8 - hot water comfort

activating imm heater

Setting range: on/off

Factory setting: off

activ. imm heat in heat mode

Setting range: on/off

Factory setting: off

activating the mixing valve

Setting range: on/off

Factory setting: off

outgoing hot water

Setting range: 40 - 65 °C

Default value: 55 °C

mixing valve amplifier

Setting range: 0.1 – 10.0

Default value: 1.0

mixing valve step delay

Setting range: 10 – 300 s

Default values: 30 s

Make settings for the hot water comfort here.

See the accessory installation instructions for function description.

activating imm heater: The immersion heater is activated here if installed in the water heater.

activ. imm heat in heat mode: Activate here whether the immersion heater in the tank (required if the alternative above is activated) will be permitted to charge hot water, if the compressors in the heat pump prioritise heating.

activating the mixing valve: Activate here whether a mixer valve for limiting the temperature of hot water from the water heater is installed.

If this alternative has been activated, you can set the outgoing hot water temperature, shunt amplification and shunt waiting time for the mixer valve.

outgoing hot water: Set the temperature at which the mixing valve is to restrict hot water from the water heater.

See the accessory installation instructions for function description.

Menu 5.3.20 - flow sensor

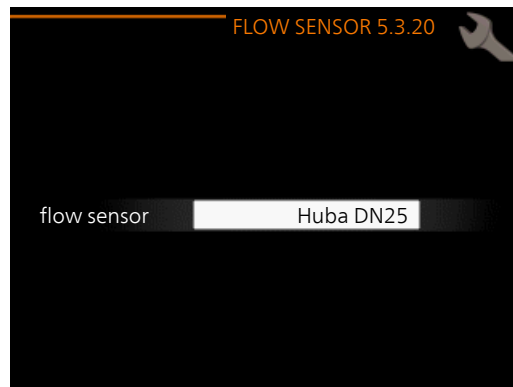

Flow sensor

Setting option: Huba DN25; Huba DN20; Huba DN15

Factory setting: Huba DN25

Here you select the size of the flow sensor that is used for the energy measurement.

Menu 5.4 - soft in/outputs

Here you can select the in/output on the input board (AA3) and the terminal block (X2) the external contact function (page 24) must be connected to.

Selectable inputs on terminal blocks AUX1-6 (AA3-X6:9-14 and X2:1-4) and output AA3-X7.

Menu 5.5 - factory setting service

All settings can be reset (including settings available to the user) to default values here.



NOTE

When resetting, the start guide is displayed the next time the control module is restarted.

Menu 5.6 - forced control

You can force control the different components in the control module and any connected accessories here.

Menu 5.7 - start guide

When the control module is started for the first time the start guide starts automatically. Start it manually here.

See page 29 for more information about the start guide.

Menu 5.8 - quick start

It is possible to start the compressor from here.



Caution

There must be a heating or hot water demand to start the compressor.



Caution

Do not quick start the compressor too many times over a short period of time as this may damage the compressor and its surrounding equipment.

Menu 5.9 - floor drying function

length of period 1 – 7

Setting range: 0 – 30 days

Factory setting, period 1 – 3, 5 – 7: 2 days

Factory setting, period 4: 3 days

temp. period 1 – 7

Setting range: 15 – 70 °C

Default value:

temp. period 1	20 °C
temp. period 2	30 °C
temp. period 3	40 °C
temp. period 4	45 °C
temp. period 5	40 °C
temp. period 6	30 °C
temp. period 7	20 °C

Set the function for under floor drying here.

You can set up to seven period times with different calculated flow temperatures. If less than seven periods are to be used, set the remaining period times to 0 days.

Mark the active window to activate the underfloor drying function. A counter at the bottom shows the number of days the function has been active.



TIP

If operating mode "add. heat only" is to be used, select it in menu 4.2.

Menu 5.10 - change log

Read off any previous changes to the control system here.

The date, time and ID no. (unique to certain settings) and the new set value is shown for every change.



NOTE

The change log is saved at restart and remains unchanged after factory setting.

Menu 5.11 - slave settings

Settings for installed slaves can be made in the sub menus.

Menu 5.11.1 - EB101 - 5.11.8 - EB108

Make settings for the installed slaves here.

Menu 5.11.1.1 - heat pump

Make settings for the installed slave here. To see what settings you can make, see installation manual for the relevant installed slave.

Menu 5.11.1.2 - charge pump (GP12)

op. mode

Heating/cooling

Setting range: auto / intermittent

Default value: intermittent

Set the operating mode for the charge pump here.

auto: The charge pump runs according to the current operating mode for SMO 40.

intermittent: The charge pump starts and stops 20 seconds before and after the compressor in the heat pump.

speed during operation

heating, hot water, pool, cooling

Setting range: auto / manual

Default value: auto

Manual setting

Setting range: 1–100 %

Default values: 70 %

speed in wait mode

Setting range: 1–100 %

Default values: 30 %

max. allowed speed

Setting range: 80–100 %

Default values: 100 %

Set the speed at which the charge pump is to operate in the present operating mode. Select "auto" if the speed of the charge pump is to be regulated automatically (factory setting) for optimal operation.

If "auto" is activated for heating operation, you can also make the setting "max. allowed speed" which restricts the charge pump and does not allow it to run at a higher speed than the set value.

For manual operation of the charge pump deactivate "auto" for the current operating mode and set the value to between 1 and 100 % (the previously set value for "max. allowed speed" no longer applies).

Speed in standby mode (only used if "auto" has been selected for "Operating mode") means the charge pump operates at the set speed during the time when there is neither a need for compressor operation nor additional heat.

5.12 - country

Select here where the product was installed. This allows access to country specific settings in your product.

Language settings can be made regardless of this selection.



NOTE

This option locks after 24 hours, restart of display or program updating.

9 Service

Service actions



NOTE

Servicing should only be carried out by persons with the necessary expertise.

When replacing components on SMO 40 only replacement parts from NIBE may be used.

Emergency mode



NOTE

Switch (SF1) must not be put into mode "I" or  before the installation is filled with water. The compressor in the heat pump can be damaged.

Emergency mode is used in event of operational interference and in conjunction with service. Hot water is not produced in emergency mode.

Emergency mode is activated by setting switch (SF1) in mode "". This means that:

- The status lamp illuminates yellow.
- The display is not lit and the control computer is not connected.
- Hot water is not produced.
- The compressors are switched off. Charge pump (EB101-GP12) and charge pump (EB102-GP12) (if installed) are running.
- Accessories are switched off.
- The heating medium pump is active.
- The emergency mode relay (K1) is active.

External additional heat is active if it is connected to the emergency mode relay (K1, terminal block X1). Ensure that the heating medium circulates through the external additional heat.

Temperature sensor data

Temperature (°C)	Resistance (kOhm)	Voltage (VDC)
-40	351.0	3.256
-35	251.6	3.240
-30	182.5	3.218
-25	133.8	3.189
-20	99.22	3.150
-15	74.32	3.105
-10	56.20	3.047
-5	42.89	2.976
0	33.02	2.889
5	25.61	2.789
10	20.02	2.673
15	15.77	2.541
20	12.51	2.399
25	10.00	2.245
30	8.045	2.083
35	6.514	1.916
40	5.306	1.752
45	4.348	1.587
50	3.583	1.426
55	2.968	1.278
60	2.467	1.136
65	2.068	1.007
70	1.739	0.891
75	1.469	0.785
80	1.246	0.691
85	1.061	0.607
90	0.908	0.533
95	0.779	0.469
100	0.672	0.414

USB service outlet

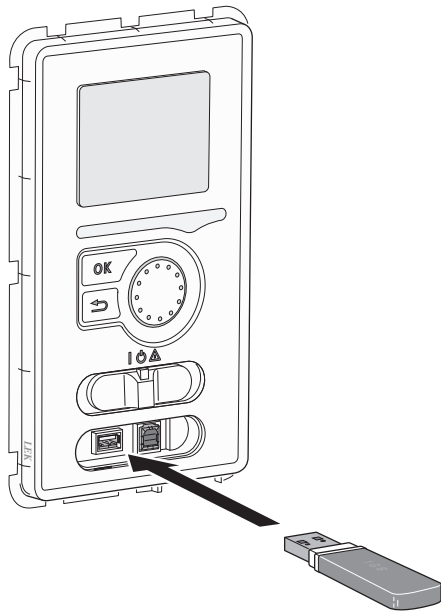

SMO 40 is equipped with a USB socket in the display unit. This USB socket can be used to connect a USB memory to update the software, save logged information and handle the settings in SMO 40.

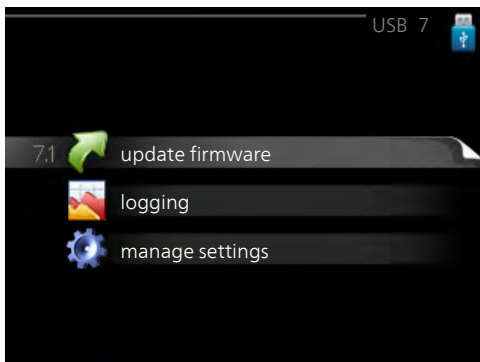
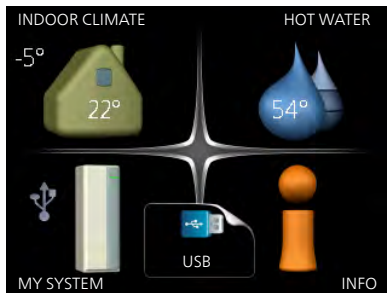

When a USB memory is connected a new menu (menu 7) appears in the display.

Menu 7.1 - update firmware

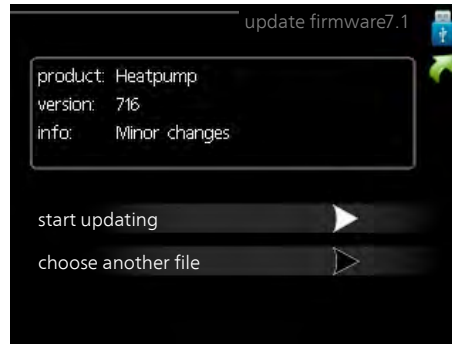

This allows you to update the software in SMO 40.



NOTE

For the following functions to work the USB memory must contain files with software for SMO 40 from NIBE.

The fact box at the top of the display shows information (always in English) of the most probable update that the update software has selected from the USB memory.

This information states which product the software is intended for, the software version and general information about them. If you wish to select another file than the one selected, the correct file can be selected by "choose another file".

start updating

Select "start updating" if you want to start the update. You are asked whether you really want to update the software. Respond "yes" to continue or "no" to undo.

If you responded "yes" to the previous question the update starts and you can now follow the progress of the update on the display. When the update is complete SMO 40 restarts.



NOTE

A software update does not reset the menu settings in SMO 40.



NOTE

If the update is interrupted before it is complete (for example power cut etc.) the software can be reset to the previous version if the OK button is held in during start up until the green lamp starts to illuminate (takes about 10 seconds).

choose another file



Select "choose another file" if you do not want to use the suggested software. When you scroll through the files, information about the marked software is shown in a fact box just as before. When you have selected a file with the OK button you will return to the previous page (menu 7.1) where you can choose to start the update.

Menu 7.2 - logging

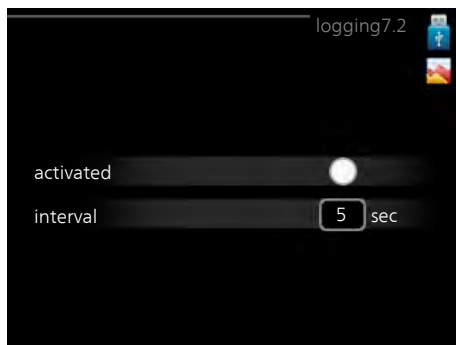

Setting range: 1 s – 60 min
Factory setting range: 5 s

Here you can choose how current measurement values from SMO 40 should be saved onto a log file on the USB memory.

1. Set the desired interval between loggings.
2. Tick "activated".
3. The present values from SMO 40 are saved in a file in the USB memory at the set interval until "activated" is unticked.

NOTE
Untick "activated" before removing the USB memory.

Menu 7.3 - manage settings

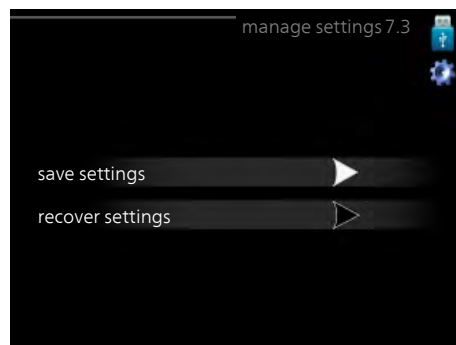

Here you can manage (save as or retrieve from) all the menu settings (user and service menus) in SMO 40 with a USB memory.

Via "save settings" you save the menu settings to the USB memory in order to restore them later or to copy the settings to another SMO 40.

NOTE
When you save the menu settings to the USB memory you replace any previously saved settings on the USB memory.

Via "recover settings" you reset all menu settings from the USB memory.

NOTE
Reset of the menu settings from the USB memory cannot be undone.

10 Disturbances in comfort

In most cases, the control module notes a malfunction and indicates this with alarms and shows instructions to rectify it in the display. See "Manage alarm" for information about managing alarms. If the malfunction does not appear in the display, or if the display is not lit, the following troubleshooting guide can be used.

Manage alarm

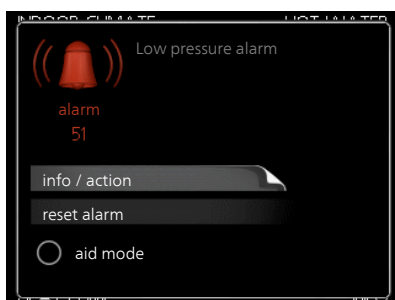

In the event of an alarm, some kind of malfunction has occurred, which is indicated by the status lamp changing from green continuously to red continuously. In addition, an alarm bell appears in the information window.

Alarm

In the event of an alarm with a red status lamp a malfunction has occurred that the heat pump and/or control module cannot remedy itself. In the display, by turning the control knob and pressing the OK button, you can see the type of alarm it is and reset it. You can also choose to set the installation to aid mode.

info / action Here you can read what the alarm means and receive tips on what you can do to correct the problem that caused the alarm.

reset alarm In most cases it is enough to select "reset alarm" to correct the problem that caused the alarm. If a green light illuminates after selecting "reset alarm" the alarm has been remedied. If a red light is still visible and a menu called "alarm" is visible in the display, the problem that caused the alarm remains. If the alarm disappears and then returns, see the troubleshooting section (page 53).

aid mode "aid mode" is a type of emergency mode. This means that the installation produces heat and/or hot water despite there being some kind of problem. This can mean that the heat pump's compressor is not running. In this case any electrical addition produces heat and/or hot water.



NOTE

To select aid mode an alarm action must be selected in the menu 5.1.4.



Caution

Selecting "aid mode" is not the same as correcting the problem that caused the alarm. The status lamp will therefore continue to be red.

Troubleshooting

If the operational interference is not shown in the display the following tips can be used:

Basic actions

Start by checking the following possible fault sources:

- The switch's (SF1) position.
- Group and main fuses of the accommodation.
- The property's earth circuit breaker.
- The control module's miniature circuit breaker (FA1).
- Correctly set load monitor (if installed).

Low hot water temperature or a lack of hot water

This part of the fault-tracing chapter only applies if the water heater is installed in the system.

- Closed or choked filling valve for the hot water heater.
 - Open the valve.
- Mixing valve (if there is one installed) set too low.
 - Adjust the mixer valve.
- Control module in incorrect operating mode.
 - If mode "manual" is selected, select "addition".
- Large hot water consumption.
 - Wait until the hot water has heated up. Temporarily increased hot water capacity (temporary lux) can be activated in menu 2.1.
- Too low hot water setting.
 - Enter menu 2.2 and select a higher comfort mode.
- Too low or no operating prioritisation of hot water.
 - Enter menu 4.9.1 and increase the time for when hot water is to be prioritised.

Low room temperature

- Closed thermostats in several rooms.
 - Set the thermostats to max, in as many rooms as possible. Adjust the room temperature via menu 1.1, instead of choking the thermostats.
- Control module in incorrect operating mode.
 - Enter menu 4.2. If mode "auto" is selected, select a higher value on "stop heating" in menu 4.9.2.
 - If mode "manual" is selected, select "heating". If this is not enough, select "addition".
- Too low set value on the automatic heating control.
 - Enter menu 1.1 "temperature" and adjust the offset heating curve up. If the room temperature is only low in cold weather the curve slope in menu 1.9.1 "heating curve" needs adjusting up.
- Too low or no operating prioritisation of heat.
 - Enter menu 4.9.1 and increase the time for when heating is to be prioritised.
- "Holiday mode" activated in menu 4.7.
 - Enter menu 4.7 and select "Off".
- External switch for changing the room heating activated.
 - Check any external switches.

- Air in the climate system.
 - Vent the climate system.
- Closed valves to the climate system.
 - Open the valves.

High room temperature

- Too high set value on the automatic heating control.
 - Enter menu 1.1 (temperature) and reduce the offset heating curve. If the room temperature is only high in cold weather the curve slope in menu 1.9.1 "heating curve" needs adjusting down.
- External switch for changing the room heating activated.
 - Check any external switches.

Low system pressure

- Not enough water in the climate system.
 - Top up the water in the climate system.

The compressor does not start

- There is no heating requirement.
 - The heat pump does not call on heating nor hot water.
- Temperature conditions tripped.
 - Wait until the temperature condition has been reset.
- Minimum time between compressor starts has not been reached.
 - Wait 30 minutes and check if the compressor has started.
- Alarm tripped.
 - Follow the display instructions.

Additional heating only

If you are unsuccessful in rectifying the fault and are unable to heat the house, you can, whilst waiting for assistance, continue running the heat pump in "add. heat only". This means that additional heating only is used to heat the house.

Set the installation to additional heat mode

1. Go to menu 4.2 op. mode.
2. Mark "add. heat only" using the control knob and then press the OK button.
3. Return to the main menus by pressing the Back button.



Caution

When commissioning without NIBE air/water heat pump an alarm communication error may appear in the display.

The alarm is reset if the relevant heat pump is deactivated in menu 5.2.2 ("installed slaves").

11 Accessories

Accessory card AXC 30

An accessory card is required if active cooling (4 pipe system), extra climate system, hot water comfort or if more than two heat pumps are to be connected to SMO 40. It can also be used for step controlled additional heat (e.g. external electric boiler), shunt controlled addition (e.g. wood/oil/gas/pellet boiler).

An accessory card is also required if for example an HWC pump is connected to SMO 40 at the same time that the buzzer alarm indication is activated.

Part no. 067 304

Auxiliary relay HR 10

Part no. 067 309

Charge pump CPD 11

Charge pump for heat pump

CPD 11-25/65

Part no. 067 321

CPD 11-25/75

Part no. 067 320

Communications module MODBUS 40

MODBUS 40 enables SMO 40 to be controlled and monitored using a DUC (computer sub-center) in the building. Communication occurs using MODBUS-RTU.

Part no. 067 144

Communications module SMS 40

SMS 40 enables operation and monitoring of SMO 40, via a GSM module, using a mobile phone via SMS messages. If the mobile telephone also has the Android operating system the mobile application "NIBE Mobile App" can be used.

Part no. 067 073

Connection box K11

Connection box with thermostat and overheating protection.

Part no. 018 893

Energy measurement kit EMK 300

Part no. 067 314

Energy measurement kit EMK 500

Part no. 067 178

External electric additional heat ELK

These accessories may require accessories card AXC 30 (step controlled addition).

ELK 5

Immersion heater

5 kW, 1 x 230 V

Part no. 069 025

ELK 8

Immersion heater

8 kW, 1 x 230 V

Part no. 069 026

ELK 15

Immersion heater

15 kW, 3 x 400 V

Part no. 069 022

ELK 26

Immersion heater

26 kW, 3 x 400 V

Part no. 067 074

ELK 42

Immersion heater

42 kW, 3 x 400 V

Part no. 067 075

Extra shunt group ECS 40/ECS 41

This accessory is used when SMO 40 is installed in houses with two or more different climate systems that require different supply temperatures.

ECS 40 (Max 80 m²)

Part no. 067 287

ECS 41 (Min 80 m²)

Part no. 067 288

Heat pump

F2030

7 kW Part no. 064 099

9 kW Part no. 064 070

F2040

8 kW Part no. 064 109

12 kW Part no. 064 092

16 kW Part no. 064 108

F2300

14 kW Part no. 064 063

20 kW Part no. 064 064

Hot water control

VST 05

Reversing valve, Cu pipe Ø22
Max heat pump size 8 kW
Part no. 089 882

VST 11

Reversing valve, Cu pipe Ø28
(Max recommended output, 17 kW)
Part no. 089 152

VST 20

Reversing valve, Cu pipe Ø35
(Max recommended output, 40 kW)
Part no. 089 388

Immersion heater IU

3 kW Part no. 018 084

6 kW Part no. 018 088

9 kW Part no. 018 090

Pool heating POOL 40

POOL 40 is an accessory that enables pool heating with SMO 40.

Part no. 067 062

Reversing valve for cooling

VCC 05

Part no. 067 311

VCC 11

Part no. 067 312

Room sensor RTS 40

Part no. 067 065

Room unit RMU 40

RMU 40 means that control and monitoring of the heat pump can be carried out in a different part of the accommodation to where SMO 40 is located.

Part no. 067 064

Solar 40

Solar 40 means that SMO 40 (together with VPAS) can be connected to solar heating.

Part no. 067 084

Solar 42

Part no. 067 153

Water heater/Accumulator tank

VPA 450/300

Water heater with double-jacketed vessel.

Copper Part no. 088 660

Enamel Part no. 088 670

VPB 200

Water heater with charge coil.

Copper Part no. 088 515

Enamel Part no. 088 517

Stainless steel Part no. 088 518

VPB 300

Hot water heater with charge coil

Copper Part no. 083 009

Enamel Part no. 083 011

Stainless steel Part no. 083 010

VPB 500

Copper lined water heater with charge coil

Part no. 083 220

VPB 750-2

Copper lined water heater with charge coil

Part no. 083 231

VPB 1000

Copper lined water heater with charge coil

Part no. 083 240

VPAS 300/450

Water heater with double-jacketed vessel and solar coil.

Copper Part no. 087 720

Enamel Part no. 087 710

12 Technical data

Dimensions and setting-out coordinates

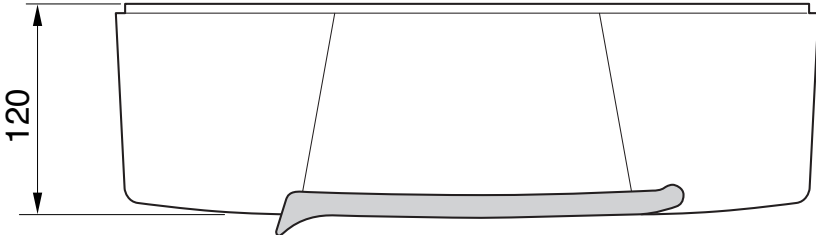
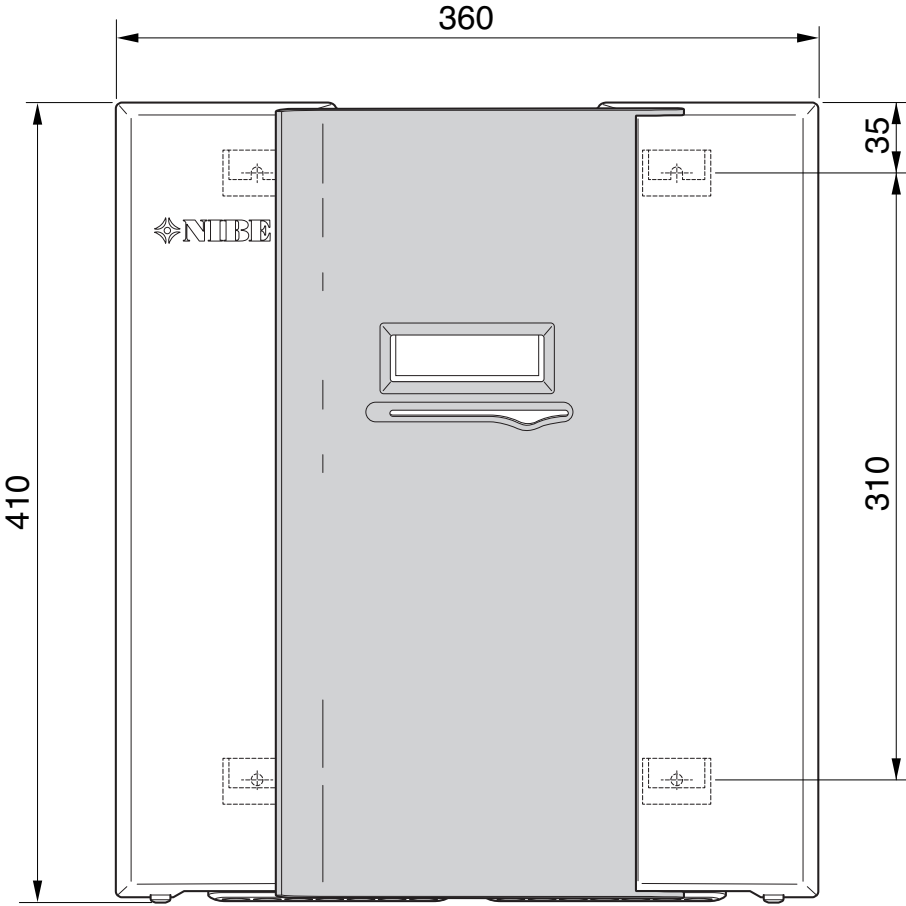
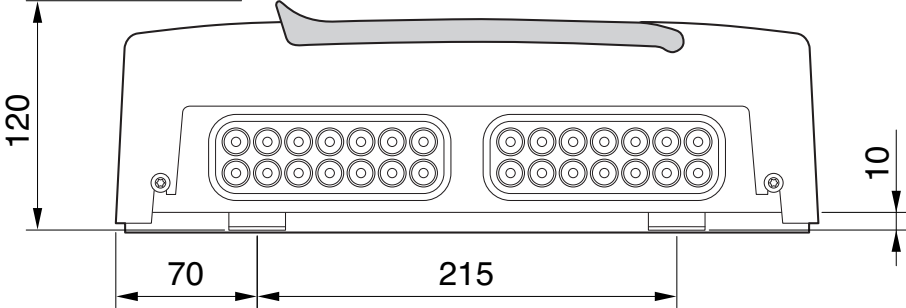

Technical specifications



SMO 40		
Electrical data		
Supply voltage		230 V ~ 50 Hz
Enclosure class		IP21
Rated value for impulse voltage	kV	4
Pollution degree		2
Optional connections		
Max number air/water heat pumps		8
Max number of sensors		8
Max number of charge pumps with internal accessory cards		4
Max number of charge pumps with external accessory cards		8
Max number of outputs for additional heat step		3

Miscellaneous		
Operation mode (EN60730)		Type 1
Area of operation	°C	-25 – 70
Ambient temperature	°C	5 – 35
Program cycles, hours		1, 24
Program cycles, days		1, 2, 5, 7
Resolution, program	min.	1
Dimensions and weight		
Width	mm	360
Depth	mm	120
Height	mm	410
Weight, (without packaging and enclosed components)	kg	5.15
Part No.		067 225

Electrical circuit diagram

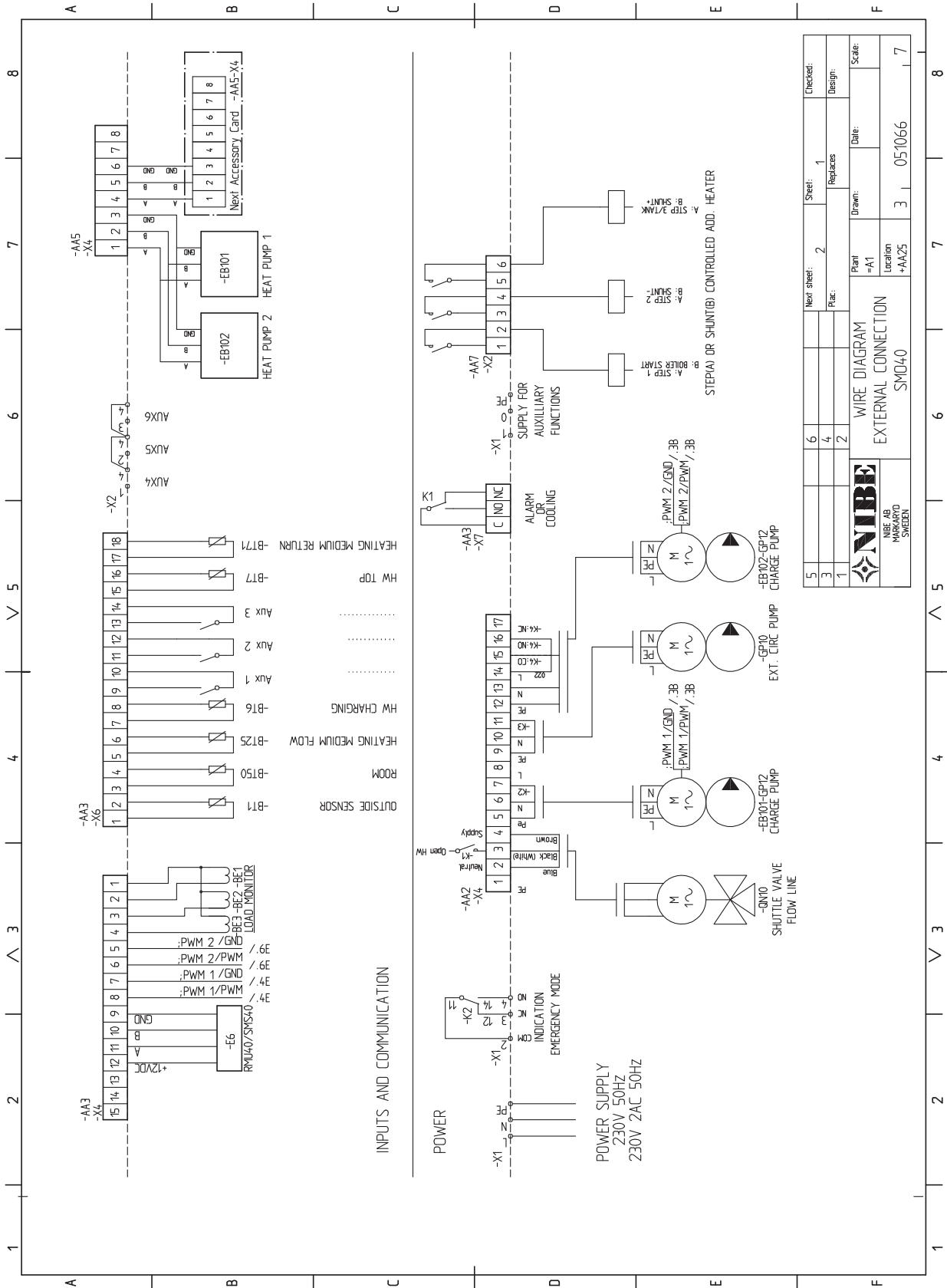

5								Checked:
3								Disign:
1								Scale:
		WIRE DIAGRAM EXTERNAL CONNECTION SMO40		Plant: A-1 Location: AA25	Drawn: 3 Date: 05/10/66	Sheet: 1 Replaces:	Checked:	

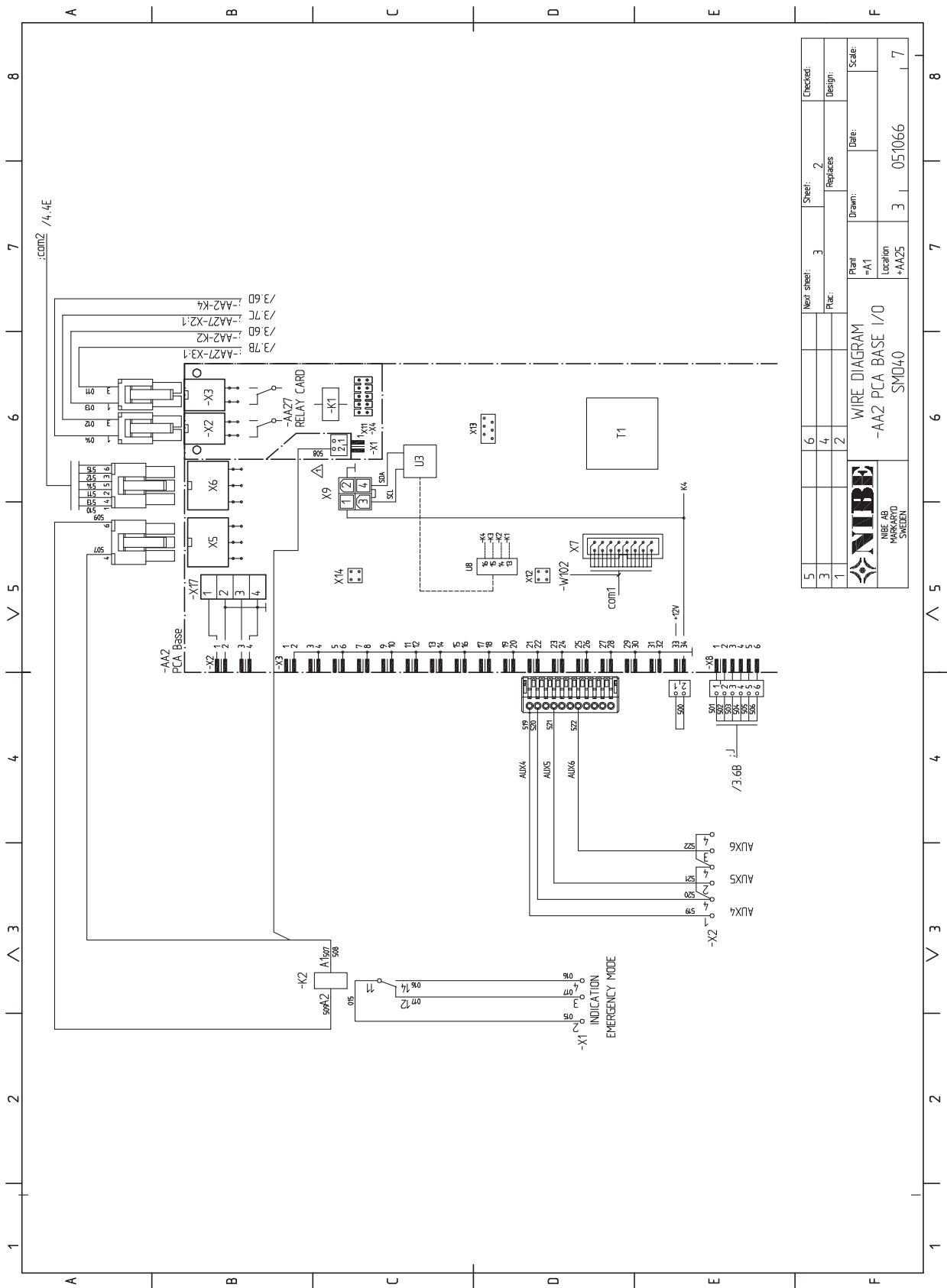

5	Next sheet:	3	Sheet:	2	Checked:
3	Plat.:	4	Replaces:	Design:	
1		2	Drawn:	Date:	Scale:
 NIBE AB INDUSTRIAL SYSTEMS			WIRE DIAGRAM -AA2 PCA BASE I/O SMD40		
			Plant:	=A1	
	Location:	+AA25	3	051066	7

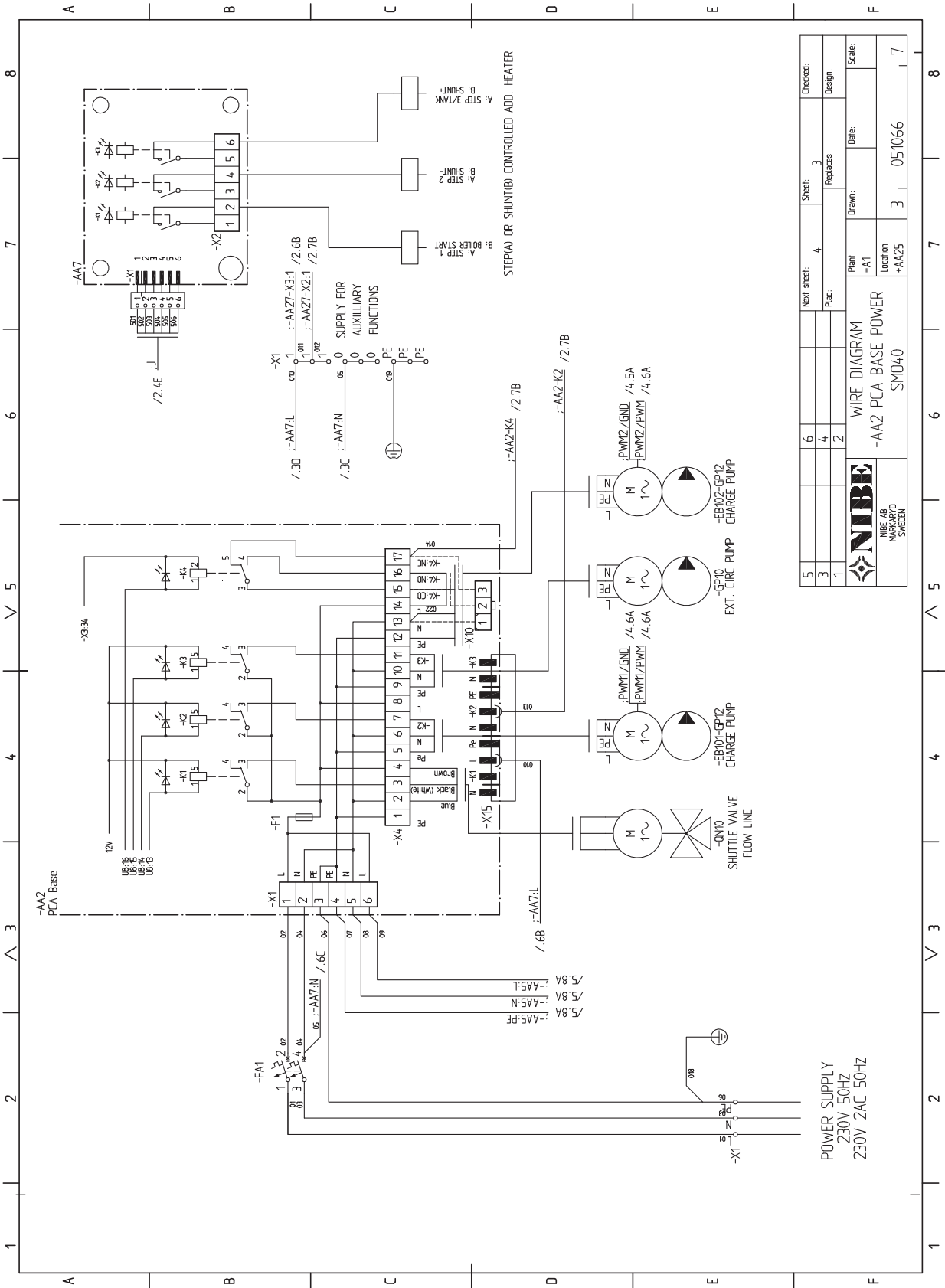

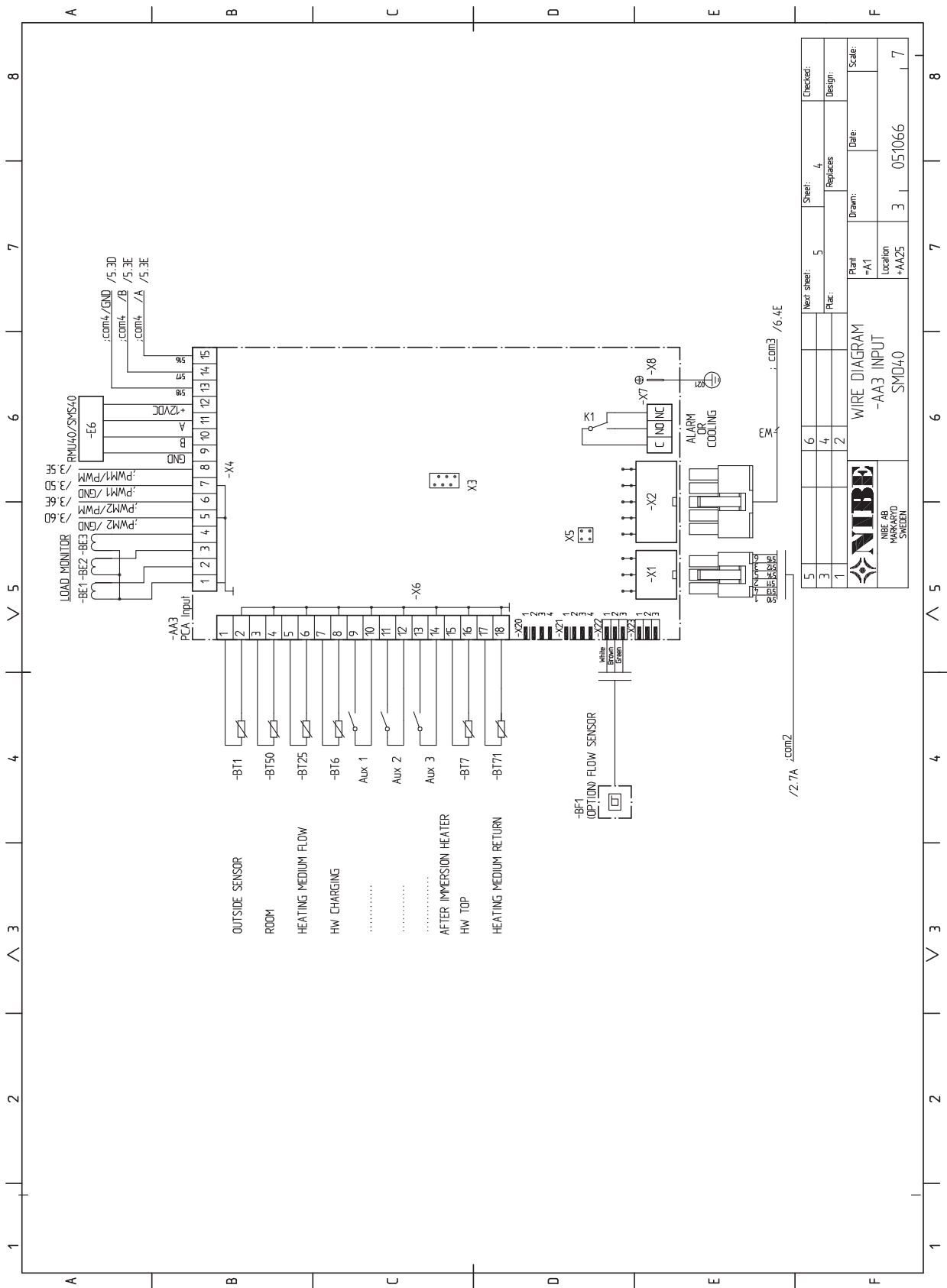

5	6	Next sheet:	3	Checked:
3	4	Replaces:		Design:
1	2	Plant:		Scale:
 NIBE AB MARKARYD SWEDET		Plant:	-A1	Date:
		Location:	+AA25	051066
		Drawn:	3	7

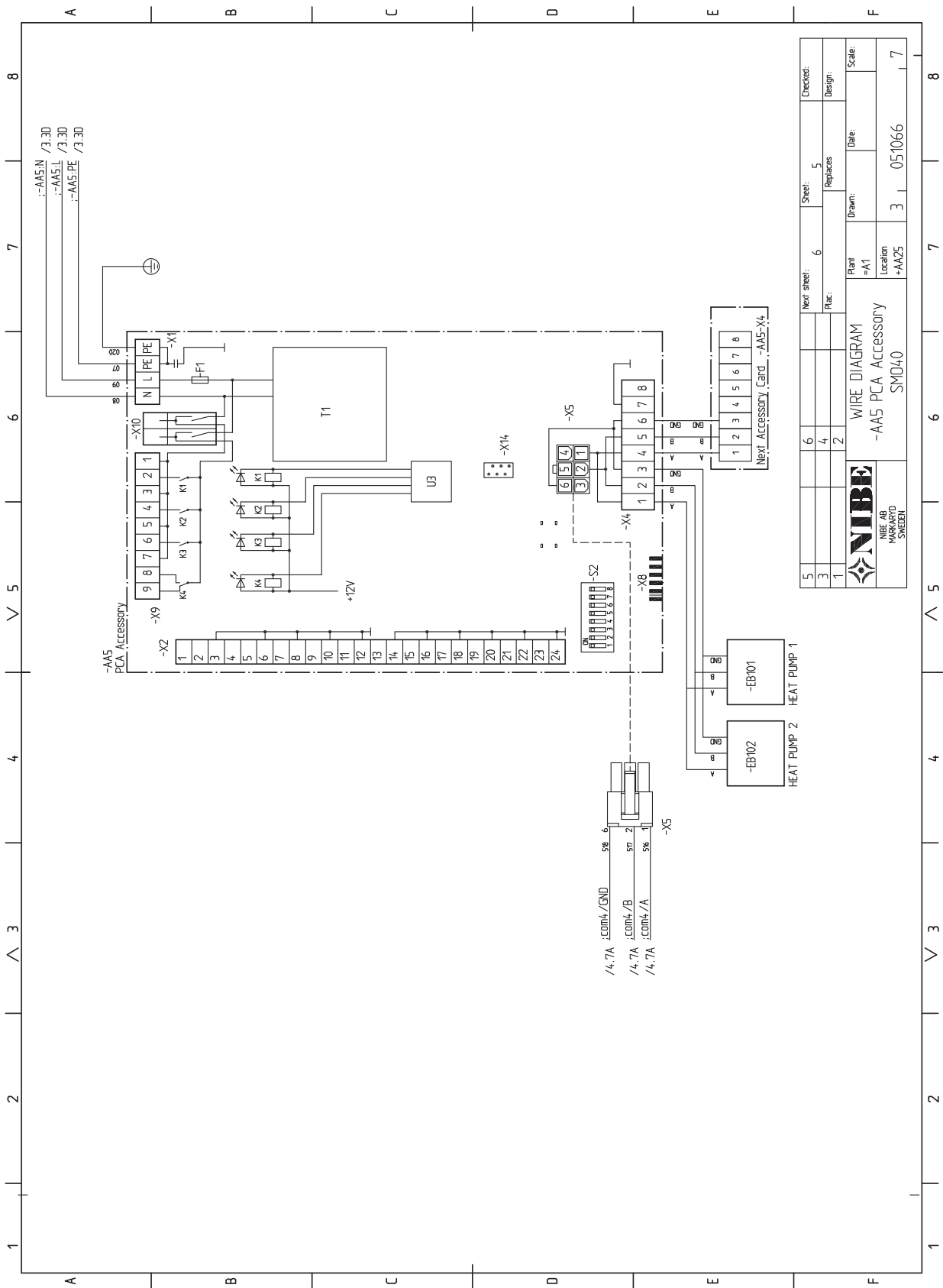

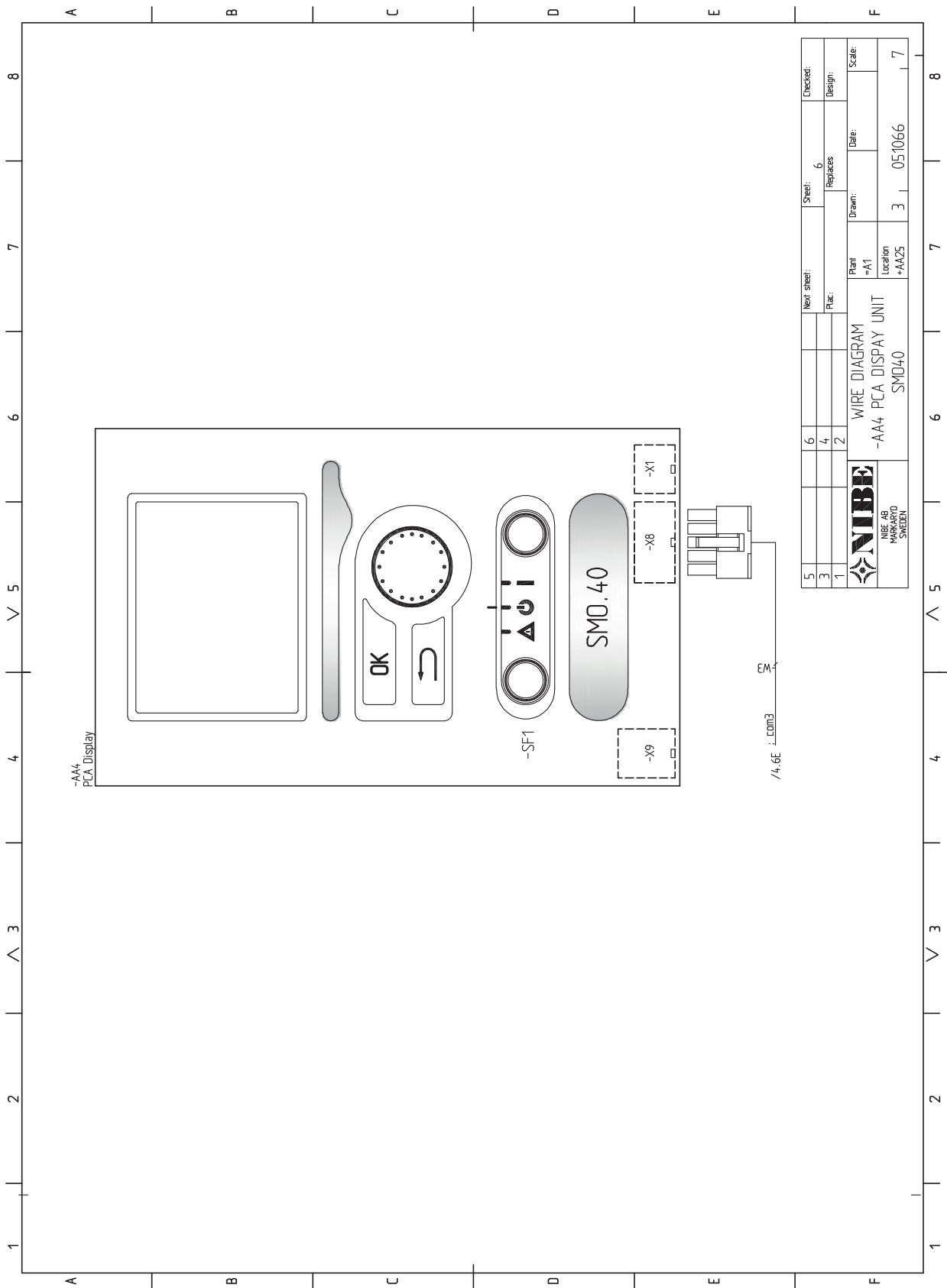

5	Next sheet:	6	Sheet:	5	Checked:			
3	Plac.:	2	Replaces:	6	Design:			
1	 NIBE AB MARKARYD SWEDET				Scale:			
WIRE DIAGRAM								
-AA5 PCA ACCESSORY								
SMD40					Date:			
					Drawn:			
					Plant			
					Location			
					+AA25			
					3			
					051066			
					7			



5				Next sheet:	Sheet: 6	Checked:
3				Replaces:	Design:	
1				Plac:	Drawn:	Scale:
 NIBE NIBE AB KONTORSTADEN SWEDEN				WIRE DIAGRAM -AA4 PCA DISPLAY UNIT SMO.40		Date:
				Plant: -A1	Date: 051066	
				Location: +AA25	3	7

13 Item register

Item register

- A**
 - Accessibility, electrical connection, 16
 - Accessories, 55
 - Alarm, 53
- B**
 - Back button, 34
- C**
 - Cable lock, 17
 - Commissioning and adjusting, 28
 - Commissioning with additional heating only, 28
 - Commissioning with NIBE air/water heat pump, 28
 - Cooling mode, 28
 - Pool, 32
 - Preparations, 28
 - Setting hot water circulation, 32
 - Setting the cooling/heating curve, 30
 - SG Ready, 33
 - Start guide, 29
 - Commissioning with additional heating only, 28
 - Commissioning with NIBE air/water heat pump, 28
 - Communication with heat pump, 19
 - Connecting accessories, 27
 - Connecting current sensors, 21
 - Connecting the charge pump for the heat pump, 18
 - Connections, 18
 - Contact for activation of "external adjustment", 25
 - Contact for activation of "temporary lux", 25
 - Contact for external tariff blocking, 24
 - Contact information, 6
 - Control, 34, 38
 - Control - Introduction, 34
 - Control - Menus, 38
 - Control - Introduction, 34
 - Display unit, 34
 - Menu system, 35
 - Control knob, 34
 - Control - Menus, 38
 - Menu 5 - SERVICE, 41
 - Cooling mode, 28
 - Cooling mode indication, 26
- D**
 - Delivery and handling, 7
 - Mounting, 7
 - Supplied components, 7
 - Display, 34
 - Display unit, 34
 - Back button, 34
 - Control knob, 34
 - Display, 34
 - OK button, 34
 - Status lamp, 34
 - Switch, 34
 - Disturbances in comfort, 53
 - Alarm, 53
 - Manage alarm, 53
 - Only additional heat, 54
 - Troubleshooting, 53
 - Docking alternatives, 10
- E**
 - Electrical connections, 15
 - Accessibility, electrical connection, 16
 - Cable lock, 17
 - Communication with heat pump, 19
 - Connecting accessories, 27
 - Connecting the charge pump for the heat pump, 18
 - Connections, 18
 - External circulation pump, 23
 - External connection options, 24
 - General, 15
 - Load monitor, 21
 - Miniature circuit-breaker, 15
 - NIBE Uplink™, 23
 - Optional connections, 21
 - Outdoor sensor, 20
 - Power connection, 18
 - Relay output for emergency mode, 23
 - Reversing valve, 23
 - Room sensor, 21
 - Shunt controlled additional heat, 22
 - Step controlled additional heat, 22
 - Temperature sensor, external flow line, 20
 - Temperature sensor, external return line, 20
 - Temperature sensor, hot water charging, 20
 - External circulation pump, 23
 - External connection options, 24
 - Contact for activation of "external adjustment", 25
 - Contact for activation of "temporary lux", 25
 - Contact for external tariff blocking, 24
 - Cooling mode indication, 26
 - Extra circulation pump, 26
 - Hot water circulation, 26
 - Possible selection for AUX inputs, 24
 - Possible selection for AUX output (potential free variable relay), 26
 - Switch for "Smart Grid ready", 24
 - Switch for activation of external alarm, 25
 - Switch for external blocking of function, 25
 - Temperature sensor, cooling/heating, 24
 - Temperature sensor, flow line cooling, 24
 - Temperature sensor, hot water top, 20
 - Temperature sensor, supply line after additional heating, 24
 - Extra circulation pump, 26
- H**
 - Help menu, 29, 37
 - Hot water circulation, 26
- I**
 - Important information, 4
 - Safety information, 4
 - Inspection of the installation, 5
- L**
 - Load monitor, 21
- M**
 - Manage alarm, 53
 - Marking, 4
 - Menu 5 - SERVICE, 41
 - Menu system, 35
 - Help menu, 29, 37
 - Operation, 36
 - Scroll through the windows, 37
 - Selecting menu, 36
 - Selecting options, 36
 - Setting a value, 36
 - Use the virtual keyboard, 37
 - Miniature circuit-breaker, 15
 - Mounting, 7
- N**
 - NIBE Uplink™, 23
- O**
 - OK button, 34

Only additional heat, 54
Operation, 36
Optional connections, 21
Outdoor sensor, 20

P

Pipe connections, 9
 Docking alternatives, 10
 General, 9
 Symbol key, 9
Pool, 32
Possible selection for AUX inputs, 24
Possible selection for AUX output (potential free variable relay), 26
Power connection, 18
Preparations, 28

R

Relay output for emergency mode, 23
Reversing valve, 23
Room sensor, 21

S

Safety information, 4
 Contact information, 6
 Inspection of the installation, 5
 Marking, 4
 Serial number, 4
 Symbols, 4
Scroll through the windows, 37
Selecting menu, 36
Selecting options, 36
Serial number, 4
Service, 50
 Service actions, 50
Service actions, 50
 Standby mode, 50
 Temperature sensor data, 50
 USB service outlet, 51
Setting a value, 36
Setting hot water circulation, 32
Setting the cooling/heating curve, 30
SG Ready, 33
Shunt controlled additional heat, 22
Standby mode, 50
Start guide, 29
Status lamp, 34
Step controlled additional heat, 22
Supplied components, 7
Switch, 34
Switch for "Smart Grid ready", 24
Switch for activation of external alarm, 25
Switch for external blocking of function, 25
Symbol key, 9
Symbols, 4

T

Technical data, 57
 Technical Data, 58
Technical Data, 58
Temperature sensor, cooling/heating, 24
Temperature sensor, external flow line, 20
Temperature sensor, external return line, 20
Temperature sensor, flow line cooling, 24
Temperature sensor, hot water charging, 20
Temperature sensor, hot water top, 20
Temperature sensor, supply line after additional heating, 24
Temperature sensor data, 50
The Control Module Design, 8
 Component locations, 8
 List of components, 8
Troubleshooting, 53

U

USB service outlet, 51
Use the virtual keyboard, 37

NIBE AB Sweden
Hannabadsvägen 5
Box 14
SE-285 21 Markaryd
info@nibe.se
www.nibe.eu



231760